

Abercrombie & Kent
2018-2019



LUXURY
EXPEDITION
CRUISES



MAGICAL VOYAGES FOR MAGICAL PLACES

There is no more extraordinary way to see the wilderness of jaw-dropping Antarctica, the polar bear kingdoms of the far North and even the epic Northwest Passage than on an A&K Luxury Expedition Cruise. Every voyage is designed by our experts to rise to the occasion of these unparalleled places with a level of luxury and expedition experience not found on any other cruise.

This is A&K's signature style and you can expect to find it expressed in every facet of our award-winning voyages. Step aboard spectacular sister ships with guaranteed balcony staterooms or suites for all guests, only when exclusively chartered by A&K. Explore alongside our deeply experienced Expedition Team, boasting Polar Medal winners and acclaimed scientists and historians, enjoying one of the most intimate personnel-to-guest ratios on polar seas, all of it part of an inspiring and truly unmatched A&K expedition experience.

Reserve your trip of a lifetime while preferred cabins remain, choosing from four A&K voyages guaranteed to take your bucket-list adventure to incredible heights.



Geoffrey Kent

Geoffrey Kent
Founder, Chairman & CEO
Abercrombie & Kent

Follow @geoffrey_kent on Instagram

On the cover: A Weddell seal basks in the Antarctic sun before luxurious, all-balcony 'Le Boreal'
Note: This and other images throughout this brochure were captured on actual A&K polar expeditions.





2018-2019 LUXURY EXPEDITION CRUISES

ABOUT LUXURY EXPEDITION CRUISING

- 2 Expertise in the Extraordinary
- 14 The Beauty of an Exclusively Chartered Expedition Cruiser

ANTARCTICA

- 20 Introducing Antarctica
- 26 Classic Antarctica
Dec 12-23, 2018; Jan 6-17, 2019
- 32 Antarctica, South Georgia & the Falkland Islands
Dec 22, 2018-Jan 7, 2019; Jan 16-Feb 1, 2019

THE ARCTIC

- 40 Introducing the Arctic
- 46 Arctic Cruise Adventure:
Norway, Greenland & Iceland
Jul 27-Aug 10, 2018
- 54 The Northwest Passage:
From Greenland to the Bering Sea
Aug 18-Sep 10, 2018

'LE LYRIAL' & 'LE BOREAL'

- 64 Luxurious Sister Ships to Take You There
- 68 'Le Lyrial'
- 72 'Le Boreal'

- 76 Terms & Conditions
- 78 The Journey Continues Online
- 80 Index



YOUR JOURNEY BEGINS HERE

Contact an A&K travel consultant today by calling **800 323 7308** Monday through Friday (8-7 CT) and on Saturday (9-1 CT), or speak to your travel professional. Find more information online at abercrombiekent.com.

“Amazing! Our most incredible journey in all aspects
in our long travel history. Thank you for an Antarctic trip
that simply cannot be explained with words!”

— Daniel; Troy, MI, December 2016



EXPERTISE IN THE EXTRAORDINARY

At home in the wild polar regions, Abercrombie & Kent expresses our unparalleled mastery in Luxury Expedition Cruising as an artful combination of passion, experience, dynamic orchestration and the very best experts in the region.



VISIONARIES IN LUXURY EXPEDITION CRUISING

Plying polar waters for more than 25 years, A&K continues to set the standard for modern-day luxury expedition cruising.

Longtime Leaders in Expedition Cruising

In 1991, we launched our first voyage and set our sights on delivering the highest level of service on the best possible vessel, the then-cutting-edge 'Explorer.' We invited only the top experts in their fields to join our Expedition Team. We also delivered on a truly luxurious experience, the kind pioneered by Geoffrey Kent more than 50 years ago.

Innovation as a Matter of Style

More than 200 polar expeditions later, A&K continues to deliver the most innovative and exclusive voyages to the polar regions today. We sail on extraordinary 'Le Boreal' and 'Le Lyrial,' always featuring a balcony with every guest accommodation, and — new this season — complimentary butler service with every category of suite; these are just some of the offerings available exclusively on A&K charters. We still boast the highest personnel-to-guest ratios; every Zodiac driver we employ is also a field naturalist; and our Expedition Team still represents the best of the best in every enrichment category.

Special Places We Know By Heart

Our deep experience informs an exceptionally curated portfolio of voyages to the polar regions. This season, we invite you on **The Northwest Passage: From Greenland to the Bering Sea**, an epic journey through the full length of this rarely traversed and legendary passage. **Classic Antarctica** and **Antarctica, South Georgia & the Falkland Islands** both bring you into the heart of the incomparable Southern Ocean and within reach of its remarkable wildlife, while **Arctic Cruise Adventure: Norway, Greenland & Iceland** takes you to the northern hemisphere's most dramatic islands, where the great white polar bear roams. (Learn about each voyage on the pages that follow.)





“When people tell you
that this is the journey of
a lifetime, believe them.
And A&K is the perfect host
for this marvelous voyage.”

— Diane; Mount Dora, FL, January 2017





EXPERIENCE MEETS PASSION IN THE WILDEST OF PLACES

Backed by decades of experience both on the water and on our award-winning small-group journeys, only A&K delivers incredible luxury — even at the edges of the planet.

Dedicated Experts Behind the Scenes

Before you even set foot on your ship, every aspect of your voyage has been designed and arranged from top to bottom by A&K's Luxury Expedition Cruising staff, which collectively boast more than 50 years of polar cruising experience. Executing on this itinerary is something we trust only to the members of our Expedition Team, who know these regions like the backs of their hands and who work together behind the scenes to deliver an exceptionally seamless experience — no small feat in the world's most unpredictable environments.

Orchestration So Refined, You Won't Even Notice

Every expedition to the ever-dynamic polar regions is an adventure at heart. Yet every voyage with A&K feels like a grand stroke of great luck and perfect timing. That's because we control every aspect of our voyages, from the top-notch service to the execution of an expertly crafted and remarkably agile itinerary — one that is constantly optimized by a remarkable team who are well-versed in the many changing variables of the extreme polar regions.

Environmentally Sound Voyages

A&K operates under two important guidelines at all times: to provide our guests with comfort and safety, and to protect the integrity of our polar environments. Our expeditions exceed all environmental protocols, including those set by IAATO, AECO, the National Science Foundation, Environmental Protection Agency and the Antarctic Treaty. We educate and offer guests the opportunity to participate in important conservation efforts. Both 'Le Lyrial' and 'Le Boreal' are clean-ship certified and also employ the latest environmental practices and technology, including a computerized dynamic positioning system that eliminates the need to drop anchor in fragile marine reserves; thermal and phonic insulation in engines and propulsion systems to reduce energy consumption; the cleanest-burning marine gas oil fuel; and Zodiacs featuring fuel-efficient motors.

Safety First at All Times

Safety is first and foremost on 'Le Boreal' and 'Le Lyrial,' which are equipped with the latest communication, navigation and safety equipment. These include a Global Maritime Distress and Safety System (GMDSS) and a satellite weather system that receives real-time images of cruising conditions. Our staff and crew educate guests on safe conduct and alert them to current conditions, both at sea and ashore. Serving from an onboard medical facility, an accredited physician is available on every voyage. English is also the primary language on both ships so, in the unlikely event of an emergency, instructions will be clear.



Bob Simpson
A&K VP of Expedition
Cruising and past Chair
of the Executive
Committee of IAATO

"I am proud to lead a team that is dedicated to not only delivering an amazing experience to our guests, but to doing it in a safe and environmentally responsible way. This is our paramount objective at A&K."



THE BEST EXPEDITION TEAM, BAR NONE

In a category all their own, A&K's polar Expedition Team is comprised of a cast of real-life explorers who bring your voyage to life in a most extraordinary way.

Our People Are the Difference

From award-winning scientists, habitat conservationists and wildlife photographers to historians and recipients of the prestigious Polar Medal, A&K's Expedition Team represents a remarkable team of accomplished explorers, many of which have been sailing together for decades. Yet their credentials and expertise in Antarctica and the Arctic are matched only by their commitment to your experience, which they oversee down to the last detail.

Intimate Discoveries with Passionate Champions

On every A&K expedition cruise, look forward to enriching lectures and guidance from an average of 18 Expedition Team members, each with an average of 15 years of experience sailing with us, and representing a fantastic A&K staff-to-guest ratio of 1 to 12. You also venture out on Zodiacs piloted by seasoned field naturalists, who provide the kind of commentary and insightful conversation only an experienced insider could.



Jannie Cloete
Culture enthusiast and
A&K Cruise Director
since 2003

“Our A&K Expedition Team is full of true explorers, each of them passionate about the area we sail in, passionate about what they see and passionate about sharing this with our guests. You would have to go to great lengths to find a more professional and experienced group of experts in the field.”





MEET THE HEROES OF YOUR VOYAGE

On every A&K cruise, sail with an average of 18 Expedition Team members, each representing the very best in their fields.

Passionate Scientists & Modern Day Explorers

Imagine seeing your first wandering albatross — the largest seabird in the world — alongside A&K Ornithology Lecturer Dr. Patricia Silva, editor of IAATO's *Save the Albatross* newsletter. Or cruising by Zodiac with Marine Mammal Lecturer Larry Hobbs, former principal research scientist at the National Marine Mammal Laboratory, as humpback whales feed right before you. You may also find yourself captivated by amazing-but-true tales from Naturalist & Zodiac Driver Russ Manning, a former British Royal Marines Commando, or A&K Exploration Lecturer and Arctic dogsled explorer Mike Beedell. No matter the moment, be ready to catch the contagious passion of A&K's Expedition Team during your voyage at the wondrous edges of the planet.

At Home in Native Lands

Many of our guides have been breathing the cool air of the polar regions for decades, if not a lifetime. Decorated with awards and eponymous islands, these adventurers are at home in the poles, where key moments of their lives have taken shape. Look to meet welcoming "locals" inspired to share their home with you, including: Culture Lecturer Margaret Bertulli, a former Arctic archaeologist with Parks Canada; Naturalist & Zodiac Driver Peter Clement, a Falkland Islands native raised on a sheep ranch; and History Lecturer Bob Burton, a British Antarctic Survey veteran and former Director of the South Georgia Museum (who can also attest to the labors of weeding Earnest Shackleton's grave).



MEET YOUR GUIDES ONLINE



Discover every extraordinary member of A&K's Expedition Team with complete biographies at abercrombiekent.com







PHOTO COACHING FOR AMATEURS AND EXPERTS

Every voyage we lead offers the chance to hone your skills under the wing of A&K's professional photography coaching team.

The World's Most Photogenic Destinations

Landscape and wildlife photographers are hard-pressed to find more spectacularly dramatic destinations to photograph than Antarctica and the Arctic. From monochromatic icebergs and staggering mountains sprung up from the ocean to aquamarine waterfalls spilling down a lush coastal cliff to penguins at your feet, massive polar bears on the ice, and whales so close you can smell their breath, the polar regions are a haven for any photo enthusiast dreaming of the shot of a lifetime.

Dedicated Programming on Every A&K Voyage

Every polar expedition cruise we lead includes programming designed by A&K's very own photo coaching team. Look forward to lectures geared toward both experts and budding enthusiasts, hands-on workshops in the field, and tips and tricks for shooting on everything from mobile devices to professional SLRs.



Richard Harker
Professional photographer
and A&K Resident
Photo Coach since 2008

“Picture this beautiful scene with this intensely blue water. The leopard seal was the icing on the cake. It was just the most perfect composition. We came upon it in a Zodiac and the photo took itself.”

AN UNWAVERING COMMITMENT TO CONSERVATION

Experience the pulse of our planet in the world's most telling ecosystems, and then join us in making a difference.

Our Foundation: Abercrombie & Kent Philanthropy

Established in 1982, A&K Philanthropy (AKP) is dedicated to giving back to the vibrant environments and communities we're so privileged to explore with our guests. With 32 projects in 18 countries, we support grassroots efforts focused on education, conservation, healthcare and community enterprise.

Vital Projects in the Dramatic Polar Regions

Committed to serving as stewards for the world's wildest places, AKP, in tandem with our guests, is proud to support four projects in Antarctica and the Arctic. These include: the Agreement on the Conservation of Albatrosses and Petrels (ACAP), which develops and refines seabird bycatch mitigation measures; the South Georgia Heritage Trust's Habitat Restoration Project to eradicate an invasive rat population; Inuit Youth Arts Workshops — which donates musical instruments, art supplies and instruction to Canada's indigenous, at-risk youth; and our work supporting the Antarctica Climate Change Project.

Explore Climate Change on Classic Antarctica

Join A&K on our January 6–17, 2019, departure of **Classic Antarctica** for special programming and an A&K Philanthropy focus on our changing planet. Travelling with Dr. James McClintock, an endowed university professor and noted Antarctic research scientist, you'll witness the impact of climate change and the power of environmental conservation. Special lectures reveal how climate change is influencing marine life on the Antarctic Peninsula. Guests also enjoy a behind-the-scenes visit to the U.S. Palmer Research Station (weather permitting), arranged exclusively for A&K, and may present new scientific equipment to its scientists. For more on **Classic Antarctica**, see page 26.



To learn more about other A&K-supported projects, visit akphilanthropy.org.





Dr. James McClintock
A&K Climate Ecology
Lecturer and noted
Antarctic marine biologist

“I find that guests are awed by the sheer beauty of Antarctica and its amazing landscapes and wildlife, but equally awed in a different way by the vivid story that the continent is telling us about climate change. It is impossible to come here and not see and feel the changes happening now.”

“This cruise exceeded our expectations and we feel we have been spoiled. It will be difficult to beat!”

— Nola; Victoria, Australia, August 2016



THE BEAUTY OF AN EXCLUSIVELY CHARTERED EXPEDITION CRUISER

Every voyage with A&K begins aboard a superbly outfitted mega-yacht, selected by our experts and transformed to meet our exacting standards for luxury, adventure and safety.



REMARKABLE SAILINGS FOR 199 VERY SPECIAL GUESTS

Step aboard sleek and luxurious 'Le Lyrial' and 'Le Boreal,' both exclusively chartered by A&K for an intimate voyage unlike any other.

The Benefits of an Exclusive Charter

For every A&K voyage, we transform 'Le Boreal' and 'Le Lyrial' into our own exclusive charters and limit the number of guests we bring to just 199, far below the 264 each vessel can accommodate. This not only guarantees a private balcony with every guest accommodation, it also affords comfortable access to the ship's public spaces and one of the best personnel-to-guest ratios at 1 to 1.3, promising an optimized and more intimate experience both at sea and on land.

An Ice Class for Comfort and Adventure

Both 'Le Lyrial' and 'Le Boreal' possess an ice class rating, ideal for A&K-designed expeditions to the frozen polar regions. This class enables us to safely and confidently navigate the waters of Antarctica and the Arctic, gaining access to little-known places other vessels cannot reach.

Intimate Sailings for Unequaled Exploration

Having 199 guests grants us Category 1 status in Antarctica and access to a greater range of landing sites (companies carrying more than 200 guests are restricted to limited sites or no landings at all). Our exclusive charters allow us to work directly with our Captain and crew to optimize each itinerary and let our experienced staff target other compelling sites in the event of changing conditions. Intimate sailings also mean more one-on-one exchanges with our guides, whose knowledge of these regions will captivate you in a way that no guidebook can.

Luxury and Adventure at Sea

Strength, style and the latest nautical technology define the design of both 'Le Lyrial' and 'Le Boreal,' which also deliver an abundance of luxuries and amenities. From modern restaurants and lounges, a beautiful theater, multiple outdoor observation areas, and an elevator-serviced marina (from which you easily embark on Zodiac excursions), no other polar expedition cruisers deliver luxury and immediate, authentic access to adventure like 'Le Lyrial' and 'Le Boreal.'





“This is our fourth expedition cruise and 10th trip with A&K. We regard A&K as excellent, otherwise we would not keep on coming back.”

— Ken; Australia, September 2015





“I will not mention any names, purely so as not to forget anyone, but the entire A&K staff was wonderful. I struggle to offer any suggestions as to any improvements that could be made! Thank you!”

— Robert; London, England, January 2017



INCLUSIVE CRUISING AND ALL THE RIGHT EXTRAS

Every Luxury Expedition Cruise with A&K is all-inclusive, our way. That means we handle everything from the moment your feet step off the plane.

Pre-Cruise Hotel Stays & Signature City Tours

Your journey begins with included stays in beautifully appointed, centrally located luxury hotels, such as Palacio Duhau — Park Hyatt Buenos Aires and Montreal's Fairmont Queen Elizabeth. Enjoy unhurried time to get acquainted with fellow guests, and to explore on signature A&K-guided city tours that reveal captivating capitals and port cities from Montreal to Buenos Aires, all under the wing of the most celebrated guides in the region.

Expeditions Led by Experts in the Know

A&K is proud to represent the best Expedition Team and staff in the polar regions today, boasting not only the most experienced experts in their fields but also a deeply connected network of local guides and staff. As a guest sailing with us, enjoy their collective leadership and insightful, authentic perspective at every stage of your journey, both on board and ashore in the very special communities we visit.

A Private Balcony with Every Guest Accommodation

A&K elevates every voyage we charter aboard incredible 'Le Lyrial' and 'Le Boreal' by offering only premium accommodations for every guest — either a stateroom or suite, each of which is always outfitted with a private balcony. Guests who reserve any category of suite also enjoy another A&K exclusive: complimentary butler service throughout their voyage.

All Onboard Meals and Drinks

Inclusive cruising with A&K includes all onboard meals and unlimited house drinks throughout your voyage as well as 24-hour complimentary room service and an in-cabin breakfast menu. Internationally inspired cuisine sets the tone in two elegant restaurants, while buffet and themed dinners are best enjoyed on an al fresco terrace by the pool. Cap off incredible days with cocktails in two lounges, one of which features live music nightly.

Complimentary Gear and Equipment

A custom-designed expedition parka and backpack are provided with our compliments and are yours to keep. A&K guests are also provided with complimentary use of rental boots, waterproof pants and trekking poles, all delivered to your cabin, courtesy of our Concierge Service — an exclusive A&K offering.

Included Transfers, Port Charges and Gratuities

Arrival and departure transfers are always included with your A&K journey, regardless of when you choose to arrive or depart. Port charges, as well as all crew and staff gratuities are also included.

A Commemorative Logbook

Designed by A&K, an exclusive voyage Logbook is provided with our compliments to every guest and features day-by-day experiences, wildlife sightings, Expedition Team biographies and the very best moments from your adventure at sea.



“I return home a much more learned and calm human,
as I have been touched by a land of complete peace
and exceptional beauty — a land as it should be.”

— Tanya; Abilene, TX, January 2017





INTRODUCING ANTARCTICA

Set sail for the White Continent on an A&K luxury expedition cruise, featuring the guidance of passionate experts in the field and elegantly crafted itineraries that showcase the best of the Southern Ocean.

Classic Antarctica

December 12–23, 2018

January 6–17, 2019

Embark on a 12-day adventure to the centerpiece of the Southern Hemisphere, extraordinary Antarctica, discovering massive icebergs and wildlife in abundance.

Antarctica, South Georgia & the Falkland Islands

December 22, 2018–January 7, 2019

January 16–February 1, 2019

A panoramic 17-day journey carries you to the colorful Falkland Islands, unspoiled South Georgia with its rookeries of king penguins, and epic Antarctica.

A WORLD UNPARALLELED: THIS IS ANTARCTICA

It's impossible to prepare for the scale and wonder of Antarctica. Explored only by a lucky few, it is a place where ice-cream colors paint towering icebergs, seas burst with wildlife and a pristine ecosystem profoundly moves the human spirit.

More Than a Seventh Continent

Some see Antarctica as the seventh continent to conquer. Only to realize it's an extraordinary place beyond a bucket list, addictive in its beauty, deeply inspiring and always surprising. Change is a constant here, where the world's most important conservation research and activity takes place. And it's a powerful thing to see this evolution happening right before you.

A Land Untouched and Rarely Explored

At the edge of the map, Antarctica represents the last true wilderness, a launching pad for dramatic extremes, a place forever untamed. There is nothing as thrilling as being among the few who voyage deep into the wilds of the southern hemisphere, joining the ranks of legendary explorers like Sir Ernest Shackleton, especially for adventurers seeking the ultimate in bragging rights.

An Awe-Inspiring Wilderness

Gargantuan icebergs, towering mountains that thrust out of the ocean like a surprise, glaciers that curl over the tops of seaside cliffs, geothermal beaches and dramatic light reflected across ice-cloaked seas — count these among Antarctica's many magical displays. If that isn't enough, these landscapes serve as a backdrop for huge numbers of marine and birdlife you simply can't experience anywhere else on earth.







The march of the gentoo penguins



The Antarctic fur seal, Antarctica's only eared species

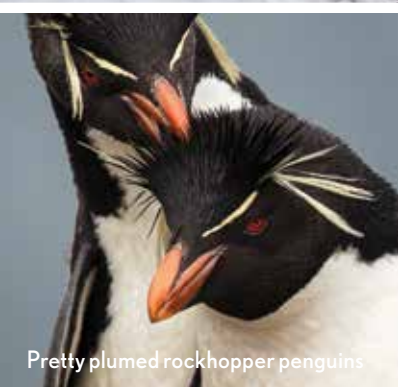

Pretty plumed rockhopper penguins



A fearsome leopard seal



Roaring elephant seals vying for turf



The Weddell seal, among Antarctica's largest pinnipeds

UNABASHED WILDLIFE BEFORE YOUR VERY EYES

Dramatic diversity and incredible scale define the wildlife of Antarctica. Colossal humpback whales dive deep into krill-rich waters, penguins toddle up and down their own highways, massive albatrosses hug the wind of your cruising vessels, and orcas hunt in deft harmony. All this happens right before your very eyes and it's a spectacle like no other.

While no true expedition comes with guarantees, exploring in the company of A&K on our expertly led voyages puts the odds for experiencing Antarctica's remarkable wildlife up close dramatically in your favor.



Humpback whales bubble net feeding



King penguins and fuzzy "Oakum Boy" chicks in South Georgia

CLASSIC ANTARCTICA

12 days from \$11,995 | Limited to 199 guests

Visiting Buenos Aires, Ushuaia, Antarctic Sound, South Shetland Islands (which may include Half Moon, Deception, Cuverville and Penguin), Paradise Bay and Lemaire Channel

Iguazu Falls Extension | 4 days from \$1,495



& A&K ADVANTAGES

- › Cruise for 10 nights aboard luxurious 'Le Lyrial' with guaranteed outside balcony accommodations for all guests, only when exclusively chartered by A&K
- › Gain a deep understanding of the region with enriching lectures by award-winning A&K experts, including historians, professional photographers and recipients of the Polar Medal
- › Begin your journey with a stay at the luxurious Palacio Duhau – Park Hyatt on beautiful Alvear Avenue in Buenos Aires
- › Experience the benefits of all-inclusive cruising with onboard gratuities, unlimited house drinks, gear, and all excursions, Zodiac rides, and port charges included on your voyage
- › Travel with A&K's renowned Expedition Team, featuring passionate scientists that include an ornithologist, marine biologist and geologist, all deeply familiar with Antarctica
- › Take advantage of convenient A&K charter flights to and from Ushuaia
- › Discover some of the world's rarest wildlife and terrain on included excursions led by the region's best guides
- › Enjoy additional programming on our January 6 departure, which features an A&K Philanthropy focus on Understanding Climate Change with special guest lecturer and noted scientist Dr. James McClintock
- › Learn about Antarctica's changing environment and efforts to conserve it



DAY 1: Arrive Buenos Aires, Argentina

Arrive this morning in Argentina's capital and transfer to your hotel, where immediate check-in has been arranged. As complex as it is energetic, this port city has been the gateway to Argentina for centuries, bringing many *porteños* (locals) into its boundaries. Although reminiscent of a European city, the spirit of Buenos Aires is evident in its diverse local neighborhoods. Experience it firsthand during an afternoon tour of the city that includes the Plaza de Mayo, the Cabildo and the Metropolitan Cathedral. Tonight, meet your fellow adventurers for a welcome cocktail reception. *Palacio Duhau — Park Hyatt Buenos Aires*

DAY 2: Ushuaia | Gateway to Antarctica

Fly to the charming port town of Ushuaia, the southernmost city in the world. On arrival, enjoy lunch at the Arakur resort and — time and weather permitting — the opportunity to take a guided trek in the Cerro Alarken Nature Reserve or simply relax with a cappuccino and enjoy the scenic views of Ushuaia and the Beagle Channel. This afternoon, arrive at your ship and settle in for your first night on board. Stylish and comfortable, 'Le Lyrial' features all-balcony staterooms and suites only on A&K journeys to Antarctica. Wander the decks to become acquainted with the ship, relax in the lounge and mingle with fellow guests in anticipation of your voyage. On departure, enjoy cruising through the beautiful Beagle Channel before heading out to sea. *'Le Lyrial' | Meals: B L D*



DAYS 3-4: Cruising the Drake Passage | Epic Passage

The journey south toward Antarctica is an exciting one. An important trade route in the 19th and early 20th centuries, the Drake Passage is a 600-mile-wide swath of water where the Southern Ocean currents are squeezed between South America's southern tip and Antarctica's northernmost reaches. Its stormy waters and icy conditions once made the journey a difficult one, though the stabilizer-equipped 'Le Lyrial' handles it with ease. As you travel in the comfort of your luxury cruiser, enjoy enriching lectures from members of the Expedition Team on topics ranging from birdlife and geology, to photography and history. After lunch, join your naturalists on the deck to look for various species of whales and abundant seabirds, which join other mammals in feasting on the krill-rich waters of the Drake Passage; it's all just a taste of the wildlife you will encounter in the days to come. Later in the evening, chat with experts about the wildlife spotted today and discuss the next day's itinerary. *'Le Lyrial' | Meals: B L D*



DAYS 5-9: Antarctica | *The White Continent*

As the Antarctic Peninsula and its offshore islands appear on the horizon, a sense of excitement begins to build. While day-to-day itineraries depend on weather, ice and wildlife conditions, daily excursions carefully planned by your Captain and Expedition Team may include exploration of the following areas:

Antarctic Sound: At the northernmost tip of the Antarctic mainland, this body of water features some of the best sightseeing on the peninsula and a proliferation of giant icebergs. Noted for its vast numbers of bird species, the sound is home to the largest breeding colonies of Adélie penguins in Antarctica. Landings here may include Paulet, Vortex or Terror islands. You may also make your first continental landing at sites such as Brown Bluff or Esperanza Station at Hope Bay.

South Shetland Islands: Antarctic research stations, remarkable history, amazing geological features and abundant wildlife define these islands off shore of the Antarctic Peninsula. Island visits may include Penguin, Half-Moon and Deception, where you may cruise into this flooded caldera to explore geothermal black sand beaches and abandoned whaling stations.

Danco Coast: Boardering the South Shetland Islands along the Antarctic continent, the Danco Coast is famed for its scenic, jaw-dropping waterways. From the comfort of 'Le Lyrial,' you may sail through the Gerlache Strait, Paradise Bay and photogenic Lemaire Channel. Landings may include Neko Harbour, Cuverville Island and Wilhelmina Bay.



Each cruise day begins with an early breakfast followed by a morning excursion on swift Zodiacs (sturdy inflatable boats). Guided by expert drivers, each Zodiac excursion is accompanied by lecturers and joined by groups of no more than 10 guests. After mornings discovering native species and striking terrain,

DECEPTION ISLAND

History meets geological wonder on this active volcanic island with geothermal hot springs and a "deceptive" ice-free harbor, once a hub for the whaling industry.



WHALES GALORE

Humpback, minke, blue, orca and fin – these are among the 10 species of whales commonly found in remarkable numbers in the waters surrounding Antarctica, and a thrill to see from many vantage points with A&K.





JOURNEY HIGHLIGHTS

Expect more than one crowning moment on A&K's Classic Antarctica voyage, including these unforgettable highlights.



UNDERSTANDING CLIMATE CHANGE

On our January 6 departure, discover the impact of climate change firsthand alongside A&K's climate change expert Dr. James McClintock, who also leads you to Antarctic research site Palmer Station (conditions permitting).

EXPERT PHOTOGRAPHY COACHING

Every voyage we lead is joined by an A&K photo coach, ready to share tips and workshops that will have you shooting like a pro – whether on a mobile phone or an SLR.



SEE THE BEST OF ANTARCTICA NOW



Check out our blog and videos to follow our most recent Antarctica voyage, exploring alongside our Expedition Team as they lead guests to the best of the White Continent.

abercrombiekent.com/blog



return to 'Le Lyrial' for lunch, and time to relax and observe the wildlife-rich waters that surround you, searching for everything from fin whales, humpback whales and orcas, to Antarctic and imperial shags. By afternoon, set out for the day's second excursion, which may include visiting a working scientific research station, hiking on a sheltered beach packed with basking Southern elephant seals, or circumnavigating colossal icebergs that serve as floating homes to seals and penguins. After full days of adventure, evenings aboard your luxury cruiser invite you to unwind over cocktails in the cozy lounge before dinner in the elegant dining room. At night, choose to recap the day's discoveries with your naturalist guides; chat on deck with fellow guests; or seize the opportunity to capture photos in the stunning low light characteristic of Antarctica's long, ethereal twilight. *'Le Lyrial' | Meals: B L D*

DAYS 10-11: Cruising the Drake Passage | *Memorable Return*
Bid farewell to wondrous Antarctica and begin your cruise back to Ushuaia at the southernmost tip of Argentina. The ship's return through the Drake Passage is an interlude for recap and

reflection, with time to compare notes with your expert lecturers on the wildlife, history and geology of the White Continent. Spend time on board with newfound friends in the comfortable common spaces of 'Le Lyrial,' enjoy quiet relaxation on your own private balcony or absorb more fascinating lectures by your captivating Expedition Team. While cruising through this historic passage, you may spot various species of whales and seabirds, including the elusive albatross and the giant petrel, an opportunistic predator and scavenger nicknamed the "stinker." The immense albatross is an especially stunning sight to behold. These wandering birds boast a wingspan approaching 12 feet and are capable of gliding through the air for hours at a time in search of food. *'Le Lyrial' | Meals: B L D*

DAY 12: Depart Ushuaia

'Le Lyrial' docks at Ushuaia this morning. After breakfast, bid farewell to your crew and fellow guests before disembarking. Transfer to the airport for your return flight to Buenos Aires, where you connect to your international flight home. *Meals: B*

Iguazu Falls Pre-Cruise Extension

4 days from \$1,495

Internal air from \$390 (Buenos Aires/Iguazu/Buenos Aires)



DAY 1: Arrive in Buenos Aires, where you are met and transferred to your historic hotel in the heart of the city.

Palacio Duhau — Park Hyatt Buenos Aires

DAY 2: Fly to Iguazu Falls and explore the Brazilian side, with its cascading waterfalls along a gulf. Join your guide on a tour through the national park to a catwalk within arm's reach of the falls. *Belmond Hotel das Cataratas | Meals: B*

DAY 3: Today, experience the Argentine side of the park, walking the trails above and along the falls. Choose to venture out on a catwalk that extends 3,600 feet over the tropical basin of the Devil's Throat. Enjoy an afternoon at leisure.

Belmond Hotel das Cataratas | Meals: B

DAY 4: Fly to Buenos Aires. Begin your main program. *Meals: B*



JAN 6 DEPARTURE

Understanding Climate Change

Sail our January 6 departure of *Classic Antarctica* for special programming and an A&K Philanthropy focus on our changing planet, joined by noted scientist Dr. James McClintock.

'LE LYRIAL' STATEROOMS & SUITES

BUTLER SERVICE INCLUDED

DATES & PRICING	Category 1	Category 2	Category 3	Category 4	Category 5	Category 6	Category 7	Category 8	Category 9
	Classic Balcony Stateroom	Deluxe Balcony Stateroom	Premier Balcony Stateroom	Prestige Balcony Suite	Premier Two-Room Balcony Suite	Privilege Two-Room Balcony Suite	Grand Deluxe Two-Room Balcony Suite	Grand Privilege Three-Room Balcony Suite	Owner's Balcony Suite
Dec 12-23, 2018	\$14,995	\$16,495	\$17,495	\$23,495	\$24,495	\$26,995	\$30,995	\$35,495	\$38,995
Early Booking Discount Price*	\$11,995	\$13,495	\$14,495						
Single Supplement	\$7,495	\$8,295	\$8,795	\$21,145	\$21,995	\$24,295	\$27,895	\$33,695	\$36,045
Jan 6-17, 2019	\$16,495	\$17,995	\$18,995	\$24,995	\$25,995	\$27,995	\$32,995	\$36,495	\$39,995
Early Booking Discount Price*	\$13,495	\$14,995	\$15,995						
Single Supplement	\$8,245	\$8,995	\$9,495	\$22,495	\$23,345	\$25,195	\$29,695	\$34,645	\$37,945

Internal Air: Economy class from \$850

Buenos Aires/Ushuaia/Buenos Aires

*Book categories 1-3 by March 31, 2018, and save up to \$6,000 per stateroom.

Journey Details

This journey contains some active elements and is subject to change based on weather, wildlife, ice and other conditions beyond A&K's control. The final itinerary will be determined at the sole discretion of the Captain and Expedition Leader. Minimum age is 10 years.

First group event: afternoon city tour on Day 1. Last group event: disembarkation in Ushuaia at 9:00 a.m. on Day 12.

Suite categories 4-9 include butler service on board 'Le Lyrial' and suite accommodations at the Palacio-Duhau – Park Hyatt Buenos Aires.



ANTARCTICA, SOUTH GEORGIA & THE FALKLAND ISLANDS

17 days from \$17,995 | Limited to 199 guests

Visiting Buenos Aires, Ushuaia, Falkland Islands, South Georgia, Scotia Sea, Antarctic Peninsula, South Shetland Islands (including sites such as Half Moon, Deception, Cuverville and Penguin), Paradise Bay and Lemaire Channel

Iguazu Falls Extension | 4 days from \$1,495

& A&K ADVANTAGES

- › Cruise for 15 nights aboard luxurious 'Le Lyrial' with guaranteed outside balcony accommodations for all guests, only when exclusively chartered by A&K
- › Begin your journey at the luxurious Palacio Duhau – Park Hyatt on beautiful Alvear Avenue in Buenos Aires
- › Gain a deep understanding of the region with enriching lectures by award-winning A&K experts, including scientists, historians and those awarded the coveted Polar Medal
- › Learn about the fascinating life of one of Antarctica's greatest explorers, Sir Ernest Shackleton, when you visit his gravesite in Grytviken, South Georgia
- › Set off for exciting shore excursions in swift Zodiacs (sturdy inflatable boats), where closer views of the land and wildlife reveal the remarkable biodiversity of the Southern Ocean
- › Experience the benefits of all-inclusive cruising with onboard gratuities, unlimited house drinks, gear, and all excursions, Zodiac rides, and port charges included on your voyage
- › Take advantage of convenient A&K charter flights to and from Ushuaia
- › Discover family-friendly programming on our December 22 departure, which features exciting youth-focused workshops on board and excursions led by dedicated Young Explorers Guides, also experienced educators



DAY 1: Arrive Buenos Aires, Argentina

Arrive in Argentina's capital city, where immediate check-in has been arranged. With its wide boulevards and classical buildings, romantic Buenos Aires boasts an energy all its own. Relax before this afternoon's tour of the city's highlights, including the Plaza de Mayo, the stately Casa Rosada, the Cabildo and the Metropolitan Cathedral. You may drive past the colorful La Boca District or San Telmo, the birthplace of tango. Get to know your fellow guests this evening at a welcome cocktail party. *Palacio Duhau — Park Hyatt Buenos Aires*



DAY 2: Ushuaia | *At the Edge of the World*

Fly to the port city of Ushuaia, located at the southern tip of South America. On arrival, enjoy lunch at the Arakur resort and, time and weather permitting, take a guided trek in the Cerro Alarken Nature Reserve or simply relax with a cappuccino and enjoy the views of Ushuaia and the Beagle Channel. Later, board 'Le Lyrial' and settle into your cabin, where you can take in views right from your own private balcony. Walk the decks and explore the common spaces as you familiarize yourself with the luxury cruiser, your home for the next 15 nights at sea. You may even want to toast to your journey in the bar with your fellow guests. *'Le Lyrial' | Meals: B L D*



DAY 3: At Sea | *Riches of the Southern Ocean*

As you sail east toward the Falkland Islands, your Expedition Team begins their informal series of enlightening daily discussions on the flora and fauna, geology, and history of the region. These expert lectures span diverse topics, such as seabirds and penguins of the Southern Ocean, the formation of sea ice over thousands of years, and personal accounts of living and working in Antarctica. Photography enthusiasts especially enjoy time with A&K's Resident Photo Coach, who is on hand to share tips and answer questions. The cool waters in these parts are rich in krill, making them a favorite with local wildlife searching for food. Alongside your naturalist guides, spot various species of whales and seabirds from 'Le Lyrial's' deck. *'Le Lyrial'* | *Meals: B L D*



DAY 4: Port Stanley, Falkland Islands | *Remote Archipelago*

Today, 'Le Lyrial' arrives at the remote Falkland Islands. Disembark to visit Port Stanley, the tiny, quaint capital with its small shops, brightly painted houses and friendly locals. Choose from one of several sightseeing excursions of Stanley, including a city highlights tour, a nature trek or an excursion by 4x4 vehicles to visit a gentoo penguin colony. History buffs may prefer a tour that visits some of the Falkland battlefields as well as the memorials to those who lost their lives in the conflict between Britain and Argentina in 1982. *'Le Lyrial'* | *Meals: B L D*



YOUNG EXPLORERS PROGRAM

On our December 22 departure, families enjoy travelling with A&K's highly-qualified Young Explorers Guides, who lead an exciting program with activities for different ages.

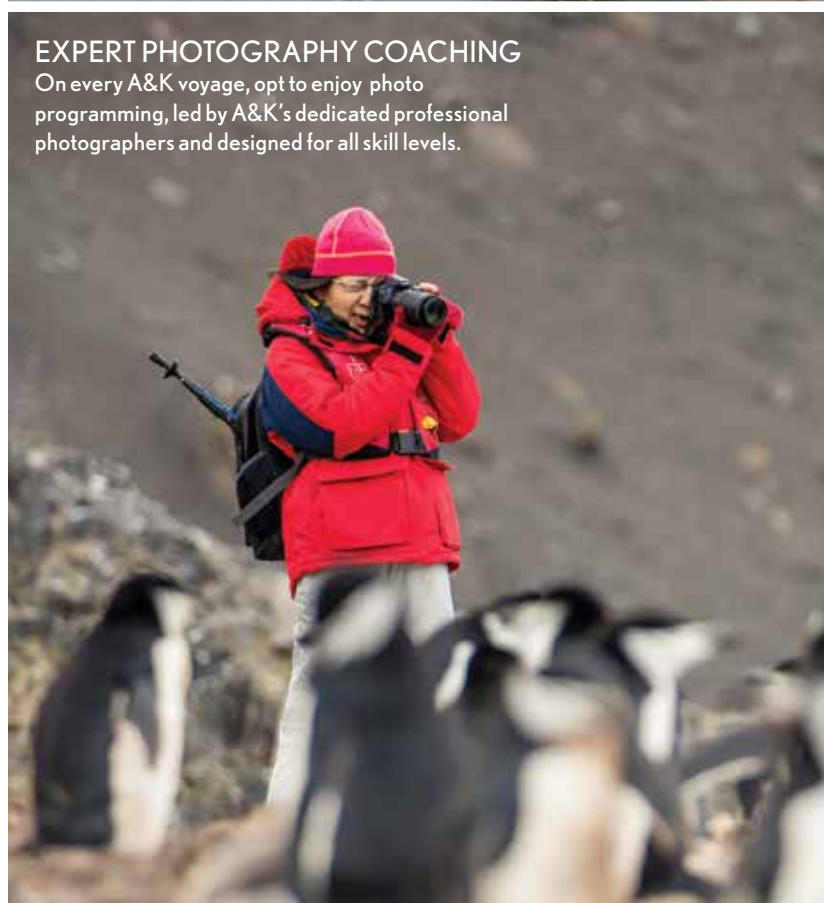

EXPERT PHOTOGRAPHY COACHING

On every A&K voyage, opt to enjoy photo programming, led by A&K's dedicated professional photographers and designed for all skill levels.



JOURNEY HIGHLIGHTS

Incredible moments fill every day on A&K's Antarctica, South Georgia & the Falkland Islands, including these highlights.

SOUTH GEORGIA ISLAND

A most remarkable wildlife location, this glaciated island is home to 30 species of birds – compared with 15 in Antarctica – including 450,000 pairs of striking king penguins.



LEGENDARY EXPLORATION

In Grytviken, visit the gravesite of famed polar explorer Sir Ernest Shackleton, whose courageous expeditions defined Antarctica's Heroic Age.



DIVE INTO THE SOUTHERN OCEAN NOW



See our blog and videos to follow our most recent voyage to Antarctica, South Georgia and the Falklands, discovering the world's most pristine wilderness in total luxury and style.

abercrombiekent.com/blog





DAYS 5-6: Cruising the South Atlantic | *Abundant Wildlife*

As you approach South Georgia, deck-side sightings of whales and other wildlife become more frequent. Time spent cruising is once again filled with informative lectures and casual talks with your guides. Scan the seas to spot marine mammals and seabirds, as the ship cruises the nutrient-rich waters past the islands of Shag Rocks. *'Le Lyrial'* | *Meals: B L D*



DAYS 7-9: South Georgia | *Footsteps of Ernest Shackleton*

South Georgia is a nearly submerged continuation of the Andes mountain range, and your days here are spent exploring its glacier-carved coves and rugged shores. While weather and ice conditions determine the schedule, stops may include Eleshul Bay to see nesting, wandering albatrosses as well as Salisbury Plain, St. Andrews Bay and Gold Harbour, all three of which are home to vast colonies of king penguins and Southern elephant seals. You may also visit Ernest Shackleton's gravesite in Grytviken alongside your onboard historian, an expert on the great explorer's life. *'Le Lyrial'* | *Meals: B L D*



DAYS 10-11: Cruising the Scotia Sea | *Antarctic Anticipation*

During your time cruising the Scotia Sea — rich with marine mammals and fish — your expert lecturers recap your adventures in South Georgia. They also share more enriching lectures, revealing more of what is to come on the Seventh Continent, from the terrain to the hardy wildlife that inhabits this dramatic environment. *'Le Lyrial'* | *Meals: B L D*



DAYS 12-14: Antarctica | *The White Continent*

Your itinerary calls for landings on the Antarctic Peninsula and a number of South Shetland Islands, which may include Half Moon, Penguin and Deception. You may also visit Deception, Cuverville and Goudier islands, and sail through Paradise Bay and the Lemaire Channel, also known as “Kodak Alley” for its picture-perfect beauty. Further adventures may include a visit to Wilhelmina Bay, noted for its prolific humpback whale activity. As you cruise along Antarctica, scan the seas daily for these gentle giants, all from the comfort of your private balcony and the outer decks of your ship. *‘Le Lyrial’* | *Meals: B L D*

DAYS 15-16: Cruising the Drake Passage | *Time for Reflection*

Bid farewell to Antarctica as ‘Le Lyrial’ points north for her return to Ushuaia. Enjoy more opportunities to observe marine and birdlife while reflecting on an incredible journey with fellow guests and new friends. *‘Le Lyrial’* | *Meals: B L D*

DAY 17: Depart Ushuaia

After breakfast, disembark your luxury expedition ship in Ushuaia. Transfer to the airport for your return flight to Buenos Aires, where you connect to your flight home. *Meals: B*

Iguazu Falls Pre-Cruise Extension

4 days from \$1,495

Internal air from \$390 (Buenos Aires/Iguazu/Buenos Aires)



DAY 1: Arrive in Buenos Aires, where you are met and transferred to your historic hotel in the heart of the city.

Palacio Duhau — Park Hyatt Buenos Aires

DAY 2: Fly to Iguazu Falls and explore the Brazilian side, with its cascading waterfalls along a gulf. Join your guide on a tour through the national park to a catwalk within arm's reach of the falls. *Belmond Hotel das Cataratas | Meals: B*

DAY 3: Today, experience the Argentine side of the park, walking the trails above and along the falls. Choose to venture out on a catwalk that extends 3,600 feet over the tropical basin of the Devil's Throat. Enjoy an afternoon at leisure.

Belmond Hotel das Cataratas | Meals: B

DAY 4: Fly to Buenos Aires. Begin your main program. *Meals: B*



DEC 22 DEPARTURE

Explore Antarctica as a Family

Choose our December 22 departure for added family programming that includes exciting workshops and special excursions led by A&K's highly qualified Young Explorers Guides.

'LE LYRIAL' STATEROOMS & SUITES

BUTLER SERVICE INCLUDED

DATES & PRICING	Category 1	Category 2	Category 3	Category 4	Category 5	Category 6	Category 7	Category 8	Category 9
Guaranteed Departure Dates	Classic Balcony Stateroom	Deluxe Balcony Stateroom	Premier Balcony Stateroom	Prestige Balcony Suite	Premier Two-Room Balcony Suite	Privilege Two-Room Balcony Suite	Grand Deluxe Two-Room Balcony Suite	Grand Privilege Three-Room Balcony Suite	Owner's Balcony Suite
Dec 22, 2018–Jan 7, 2019	\$21,995	\$23,995	\$24,995	\$31,995	\$33,495	\$36,995	\$41,995	\$45,495	\$49,995
Early Booking Discount Price*	\$17,995	\$19,995	\$20,995						
Single Supplement	\$10,995	\$11,995	\$12,495	\$28,795	\$30,145	\$33,295	\$37,795	\$43,195	\$47,495
Child (7-18) sharing with adult(s) (includes additional family programming)	\$10,995	\$11,995	\$12,495						
Jan 16–Feb 1, 2019	\$23,995	\$25,995	\$26,995	\$34,495	\$34,995	\$38,995	\$43,995	\$48,495	\$52,995
Early Booking Discount Price*	\$19,995	\$21,995	\$22,995						
Single Supplement	\$11,995	\$12,995	\$13,495	\$31,045	\$31,495	\$34,995	\$39,595	\$45,995	\$50,345

Internal Air: Economy class from \$850

Buenos Aires/Ushuaia/Buenos Aires

*Book categories 1-3 by March 31, 2018, and save up to \$8,000 per stateroom.

Journey Details

This journey contains some active elements and is subject to change based on weather, wildlife, ice and other conditions beyond A&K's control. The final itinerary will be determined at the sole discretion of the Captain and Expedition Leader. Minimum age is 7 years old on the December 22 departure and 10 years old on the January 16 departure.

Special pricing is available for children ages 7-18 on December 22 departure.

First group event: afternoon city tour on Day 1. Last group event: disembarkation in Ushuaia at 9:00 a.m. on Day 17.

Suite categories 4-9 include butler service on board 'Le Lyrial' and suite accommodations at the Palacio Duhau – Park Hyatt Buenos Aires.

A large, sculptural iceberg with two people standing on a ledge. The iceberg is a deep blue color and has a complex, layered structure. The two people are small figures standing on a flat, horizontal ledge of the iceberg. The background is a clear blue sky.

“From the nature and variety to the trip length
and the weather, it was one of the best trips
I’ve been on in my life.”

— Alexander; Greenwich, CT, September 2015

A large, sculptural ice formation, possibly a sea stack or a piece of ice, dominates the left side of the frame. It has a smooth, rounded top and a more jagged, layered base. The ice is a brilliant white, contrasting sharply with the deep blue water of the sea. The sky is a clear, pale blue with a few wispy clouds. In the background, a dark, low-lying landmass is visible on the horizon.

INTRODUCING THE ARCTIC

Embark on incredible luxury expedition cruises to the awe-inspiring North, setting out in search of the King of the North or a once-in-a-lifetime voyage through the legendary Northwest Passage.

Arctic Cruise Adventure: Norway, Greenland & Iceland

July 27–August 10, 2018

Discover stunning geological wonders and wildlife, including impressive populations of polar bears, on this 15-day voyage to the Arctic's most magnificent islands.

The Northwest Passage: From Greenland to the Bering Sea

August 18–September 10, 2018

Legendary polar explorers pave the way for this epic 24-day voyage, which sails the rarely transited Northwest Passage against a show of extraordinary landscapes, culture and wildlife.

LIGHT SHOWS AND LEGENDS IN THE ARCTIC

Ethereal glows of midnight sun and starlit shows of northern lights illuminate the Arctic, inviting adventurers into a culture-rich expanse bounded by glaciers, ruled by the polar bear and traversed by the world's greatest explorers.

Land of the Midnight Sun

Even when compared with the world's other dazzling polar region, you would be hard-pressed to find a more beautiful and strange wilderness than the Arctic. Alive under the glow of the midnight sun or a swirling shower of northern lights, and spanning a geological wonderland of fire, ice and color, the Arctic reveals the rarest of wild beauties. The first to capture your heart may be the polar bear, a magnificent predator, relentless in its ability to adapt in a dramatically changing environment.

Soul-Stirring Legends

Whether to discover unknown lands, conquer an unforgiving trade route or to at last find the North Pole, the Arctic has drawn the world's greatest explorers for thousands of years. From Erik the Red to Roald Amundsen, legends and indomitable spirit live on at the top of the world — something your remarkable Expedition Team reveals in unique A&K style.

Cultures in Harmony

Masters of harmonious coexistence with the harshest of landscapes, Inuit societies have long called the remote reaches of the Arctic home. Join A&K for a warm welcome at the shores of some of these seemingly timeless communities, where Inuit drum dances are expressed as a greeting and traditional lifestyles captivate the spirit.

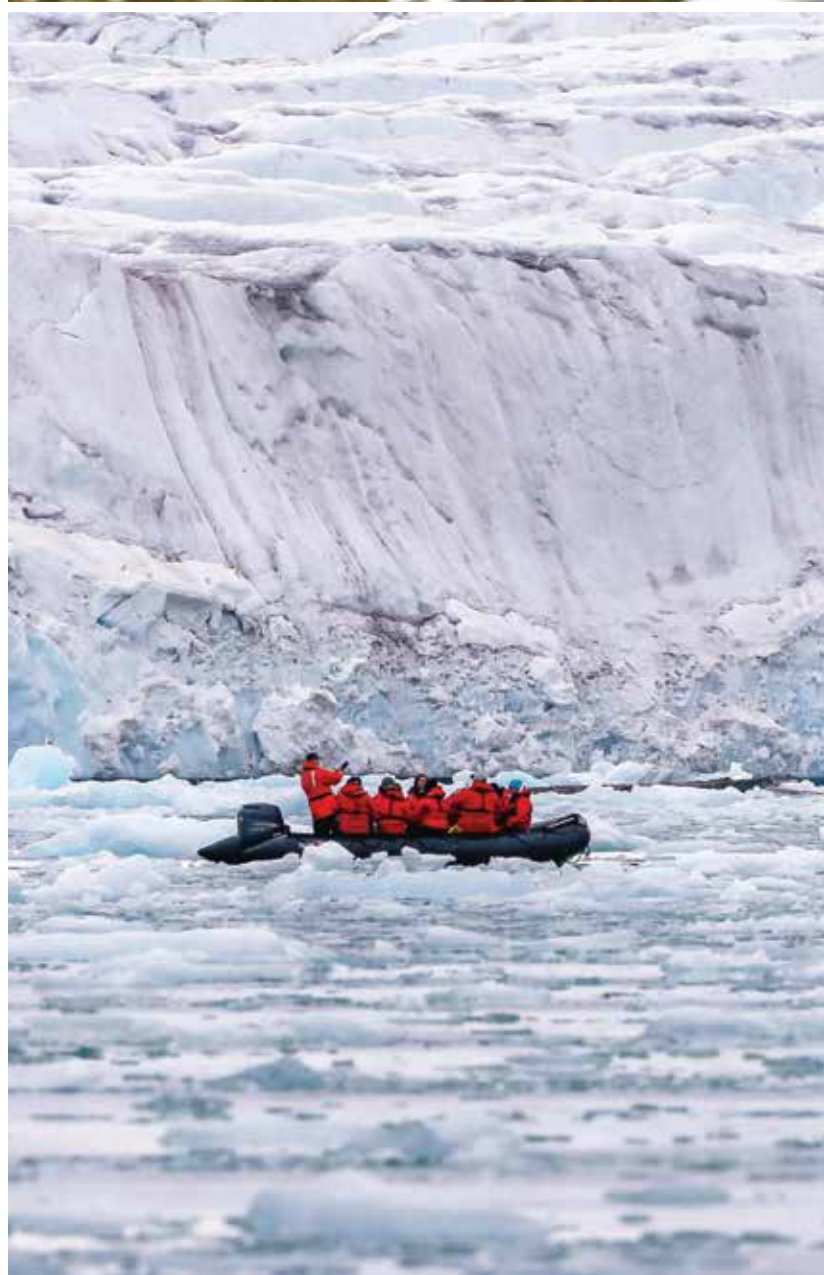





A breaching humpback whale



A herd of mustached and toothy walruses



Atlantic puffins, also known as "sea parrots"





Mother polar bear and cub

FLAMBOYANT FAUNA AT EVERY SHORE

The Arctic's icy waters and shores are home to an astounding and brilliant array of wildlife rarely found anywhere else in the world. The majestic polar bear — the King of the North — is the star of the show here, along with massive whales, some of which are only recently returning from the brink of extinction.

No true expedition offers guarantees, but you'll soon discover you're in the best possible hands with A&K's remarkable Expedition Team, who will likely find you a front-row seat to the Arctic's impressive wildlife.



Opportunistic black guillemots along the "auk cliffs"



The coat-changing Arctic fox

ARCTIC CRUISE ADVENTURE: NORWAY, GREENLAND & ICELAND

15 days from \$13,995 | Limited to 199 guests

Visiting Oslo, Longyearbyen, the Svalbard Islands,
Jan Mayen, Greenland and Iceland's West Fjords

Reykjavik Extension | 4 days from \$3,595



& A&K ADVANTAGES

- › Cruise for 13 nights through the Arctic's wild and culturally rich regions of Norway, Greenland and Iceland
- › Experience luxurious expedition ship 'Le Boreal' with guaranteed outside balcony accommodations for all guests, only when exclusively chartered by A&K
- › Travel in the company of A&K's world-class Expedition Team, seasoned experts ranging from research scientists to field naturalists
- › Explore pristine Svalbard in search of Arctic wildlife
- › Visit remote Jan Mayen island, home to an incredible birding sanctuary
- › Discover stunning Scoresby Sound in East Greenland, where you visit the Inuit village of Ittoqqortoormiit
- › Hike through Iceland's Hornstrandir Nature Reserve, a spectacular wilderness at the edge of the Arctic Circle
- › Embark on a special excursion deep inside Iceland's luminous Langjökull Glacier
- › Experience the benefits of all-inclusive cruising with onboard gratuities, unlimited house drinks, gear, and all excursions, Zodiac rides and port charges included on your voyage
- › Take advantage of a convenient A&K charter flight to Longyearbyen



DAY 1: Arrive Oslo, Norway

Arrive in Oslo, Norway's modern yet timeless capital, coexisting in close harmony with nature. On arrival, transfer to your hotel and then meet your local guide for an afternoon walking tour. This evening, join fellow guests this evening for a welcome cocktail reception. *Hotel Bristol, Oslo*



DAY 2: Longyearbyen | Long Year Town

Board a charter flight to Longyearbyen, the capital of Svalbard, also known as Spitsbergen, the sovereign Arctic archipelago of Norway. It is one of the most remote group of islands on the planet, with nearly two-thirds of its surface covered in luminous glaciers. Tour the tiny town and its Arctic Museum. Following lunch, board your expedition cruiser. *'Le Boreal' | Meals: B L D*



DAYS 3-6: Svalbard Islands | Spectacular Archipelago

Very few people have the opportunity to view the remote wilderness of the Svalbard Islands. In the Svalbard archipelago, polar bears, walruses, Svalbard reindeer and an incredibly rich variety of birds are abundant, as are cathedrals of ice, glaciers and craggy mountain peaks. An amazing amount of diminutive flora surrounds this barren landscape, which comes alive with color under summer's midnight sun. Your Captain and Expedition Team determine the day's best sightseeing opportunities, which may include these extraordinary regions:

Magdalenefjoren: A stunning fjord with rugged rock walls, Magdalenefjoren surmounts blue-hued glaciers crisscrossed by crevasses, with birds perched in the high cliffs. This “glacier coast” provides magnificent views of the slow-moving ice masses travelling out to sea as well as beaches frequented by walrus.

Ny Alesund: Once a mining town and launching pad for early Arctic expeditions, Ny Alesund is now home to a polar research station where scientists study meteorology, seismology, atmospheric sciences and marine biology. Conditions permitting, visit the small community, including a museum, art gallery and the northernmost post office in the world.

Hinlopen Strait: ‘Le Boreal’ navigates this passageway between the main island of Spitsbergen and the island of Nordaustlandet to deliver you to the Alkefjellet, or “auk cliffs,” towering rock faces that drop directly into the sea and provide a home to colonies of auks.

Wahlbergoya: Located in the center of the southern entrance to Hinlopen Strait, this island, named after Swedish botanist Peter Fredrik Wahlberg, is a favorite summer haul-out for walrus.

Monaco Bay and Glacier: Located in Northwest Spitsbergen, Monaco Bay is frequented by a variety of wildlife populations, including polar bears, walrus, harbor and bearded seals, and a multitude of seabirds.

Liefdefjorden (Loves Bay): In far northern Svalbard, this is an excellent area for spotting polar bears and other Arctic wildlife. Throughout your landings and days of cruising in Spitsbergen, your primary objective will be to search for polar bears as they hunt in their true natural habitat — be it on land or among the ice floes. Each landing is under the close supervision of your bear guardians, who have the best knowledge about where to find the white giants. *‘Le Boreal’ | Meals: B L D*



DAY 7: At Sea | *Cruising the Arctic Ocean*

As ‘Le Boreal’ plies toward remote Jan Mayen, spend the day at sea with new friends and the Expedition Team, who continue an engaging lecture series. *‘Le Boreal’ | Meals: B L D*

ITTOQQORTOORMIIT VILLAGE

A remote settlement of Greenland, this tiny village with its profusion of color is at the forefront of unique cultural visits and meetings with husky sled dogs.



“14TH OF JULY” GLACIER

In Spitsbergen on the Norwegian archipelago of Svalbard, this extraordinary glacier is actually a combination of two that merge over dark moraine.





JOURNEY HIGHLIGHTS

Remarkable experiences await on Arctic Cruise Adventure: Norway, Greenland & Iceland, including these special highlights.

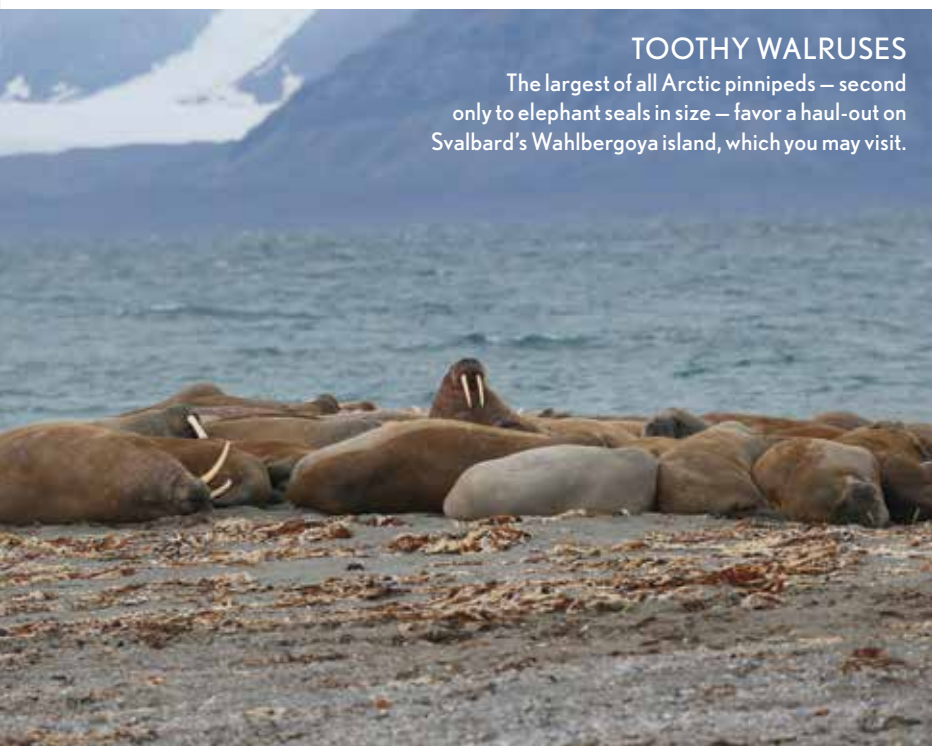

TOOTHY WALRUSES

The largest of all Arctic pinnipeds – second only to elephant seals in size – favor a haul-out on Svalbard’s Wahlbergoya island, which you may visit.



THE KING OF THE NORTH

Observe the magnificent polar bear on the Svalbard archipelago, where the bear’s numbers have steadily increased and are estimated around 3,500.



DISCOVER MORE OF THE ARCTIC NOW



Visit our blog to follow A&K’s latest voyage through the Great White North, experiencing videos, true stories and a taste of the adventures that await on an A&K luxury expedition cruise.

abercrombiekent.com/blog



DAY 8: Jan Mayen | *Glacier-Covered Volcano*

At the confluence of the Greenland and Norwegian seas, arrive at Jan Mayen, a fascinating and rugged island dominated by the 7,500-foot Beerenberg Volcano, which today stands as the world's northernmost active volcano. With special permission and conditions permitting, land on this rarely visited island to see its meteorological station Olonkinbyen and discover its phenomenal bird colonies. Designated by Birdlife International as an Important Bird Area (IBA), Jan Mayen supports large breeding colonies of northern fulmars, little auks, thick-billed guillemots and black guillemots. *'Le Boreal'* | *Meals: B L D*

DAYS 9-11: Greenland | *East Greenland & Scoresby Sound*

For the next three days, explore the rarely visited east coast of Greenland and Scoresby Sound, the largest and longest fjord system in the world. Embark on twice-daily Zodiac excursions through the fjord's glistening and intricate network, taking in its islands and icebergs, and searching for common residents that include the musk ox and reindeer. Ice conditions permitting, disembark for a visit to Ittoqqortoormiit, a small settlement founded in 1925 and one of the most isolated villages in Greenland. *'Le Boreal'* | *Meals: B L D*



DAY 12: Cruising the Denmark Strait | *Confluence of Waters*

Enjoy a relaxing day at sea cruising the relatively narrow strip of water that separates Greenland from Iceland, and connects the Arctic Sea with the Atlantic Ocean. Watch for seabirds and whales from the deck in between insightful lectures presented by your Expedition Team. *'Le Boreal'* | *Meals: B L D*



DAY 13: Iceland's West Fjords | *Hornstrandir Nature Reserve*

Today, explore the spectacular Hornstrandir Peninsula, an unspoiled wilderness on Iceland's remote West Fjords. Designated as a nature reserve in 1975 and free of any roads, Hornstrandir still appears as it would have when the Vikings first arrived. Your treks this morning reveal tranquil wildflower meadows, striking waterfalls and other geological features. This afternoon, visit the small village of Hesteyri, where you are welcomed by the local villagers. *'Le Boreal'* | *Meals: B L D*



DAY 14: Akranes | Thrilling Langjökull Glacier

The glacier-carved West Fjords continue to provide a scenic backdrop as you journey to the Langjökull Glacier. Disembark for an adventurous visit aboard special expedition trucks, stopping en route at the shimmering Hraunfossar waterfall before arriving at the entrance of Langjökull glacier. There, explore Langjökull's labyrinth of ice tunnels and caves, all revealing breathtaking shades of blue and depths of ice. Following lunch in nearby Húsafell, return this afternoon to Akranes to board 'Le Boreal.' *'Le Boreal'* | *Meals: B L D*

DAY 15: Depart Reykjavik

This morning, disembark 'Le Boreal' in Reykjavik and transfer to the airport for your return flight home, or continue on in Iceland with a Reykjavik extension. *Meal: B*



Reykjavik Post-Cruise Extension

4 days from \$3,595



DAY 1: Depart 'Le Boreal' and tour Reykjavik, the world's most northern capital. *Canopy by Hilton Reykjavik City Centre* | *Meals: L*

DAY 2: Choose from two excursions: Explore Iceland's Golden Circle, including Thingvellir National Park and the Gullfoss waterfall, or drive the rugged Thórs mörk in a 4x4 vehicle. *Canopy by Hilton Reykjavik City Centre* | *Meals: B L*

DAY 3: Today, choose from two adventures: Visit the Skógafoss waterfall and enjoy lunch, or experience the Blue Lagoon. Tonight, gather with fellow guests for a farewell cocktail reception. *Canopy by Hilton Reykjavik City Centre* | *Meals: B L*

DAY 4: Transfer to the airport for your flight home. *Meals: B*



'LE BOREAL' STATEROOMS & SUITES

DATES & PRICING	BUTLER SERVICE INCLUDED							
	Category 1	Category 2	Category 3	Category 4	Category 5	Category 6	Category 7	Category 8
Guaranteed Departure Date	Classic Balcony Stateroom	Deluxe Balcony Stateroom	Premier Balcony Stateroom	Superior Balcony Stateroom	Prestige Balcony Suite	Premier Two-Room Balcony Suite	Prestige Two-Room Balcony Suite	Owner's Balcony Suite
Jul 27-Aug 10, 2018	\$15,495	\$16,995	\$17,995	\$19,995	\$24,495	\$25,995	\$28,995	\$32,495
Early Booking Discount Price*	\$13,995	\$15,495	\$16,495					
Single Supplement	\$7,745	\$8,495	\$13,495	\$14,995	\$23,275	\$24,695	\$27,545	\$30,875

Internal Air: Economy class from \$395

Oslo/Longyearbyen

*Book categories 1-3 by Oct 31, 2017, and save up to \$3,000 per stateroom.

Journey Details

This journey contains some active elements and is subject to change based on weather, wildlife, ice and other conditions beyond A&K's control. The final itinerary will be determined at the sole discretion of the Captain and Expedition Leader. Minimum age is 10 years. Butler service is included for Suite categories 5-8.

First group event: afternoon walking tour on Day 1. Last group event: disembarkation at 9:00 a.m. on Day 15.

THE NORTHWEST PASSAGE: FROM GREENLAND TO THE BERING SEA

24 days from \$27,995 | Limited to 199 guests

Visiting Montreal, Western Greenland (Kangerlussuaq, Disko Bay, Ilulissat, Upernavik), Nunavut (Pond Inlet, Lancaster Sound, Beechey Island, Franklin Camp, Gjoa Haven, Victoria Island), Northwest Territories (Ulukhaktok, “Smoking Hills”), Yukon Territory, Beaufort and Bering Seas, Little Diomedea, Nome, and Anchorage

Anchorage Extension | 4 days from \$2,495

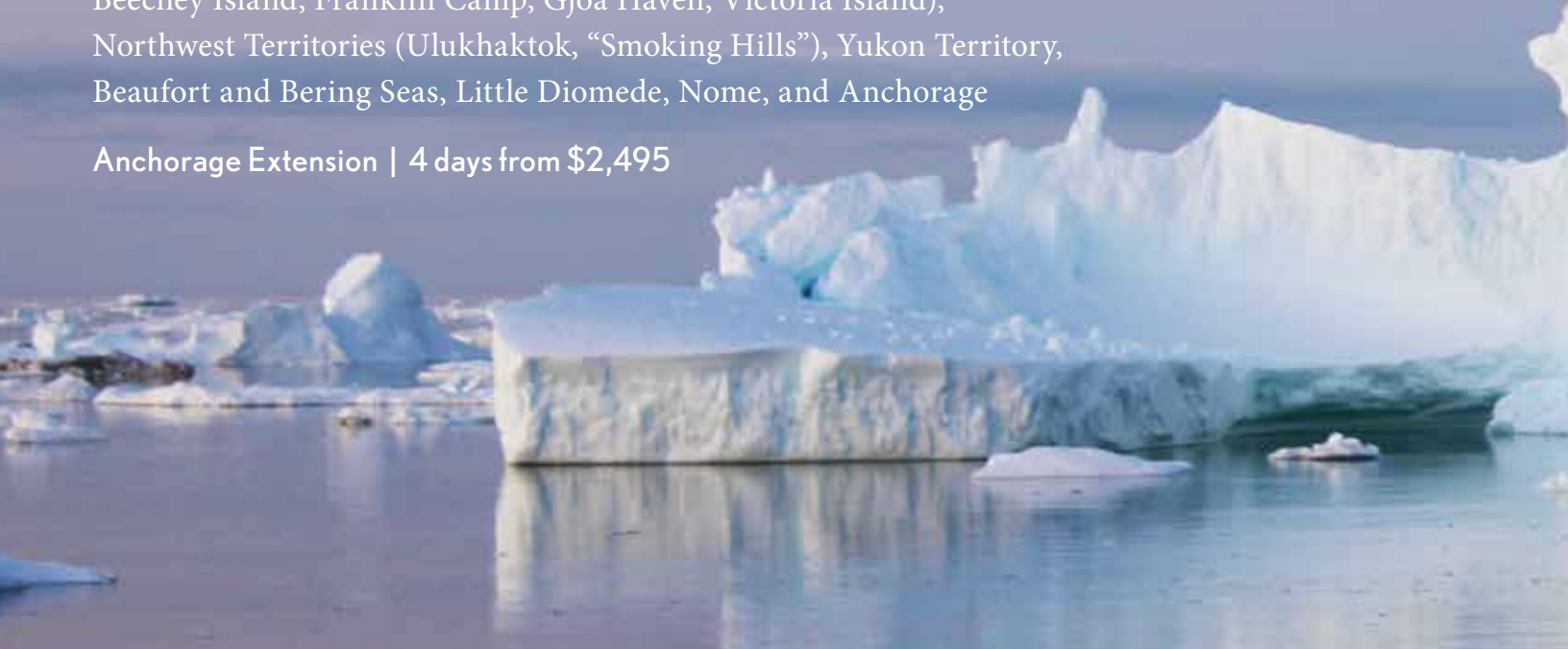

& A&K ADVANTAGES

- › Cruise the full extent of the Northwest Passage for 21 nights, voyaging from Greenland to the Canadian Arctic to the Bering Sea and ending in Alaska
- › Experience luxurious expedition ship ‘Le Boreal’ with guaranteed outside balcony accommodations for all guests, only when exclusively chartered by A&K
- › Travel in the company of A&K’s world-class Expedition Team for a deeply enriching and captivating journey
- › Discover the most historic and remote islands, fjords and harbors of this elusive passage – just as the world’s greatest polar explorers once did – with stops that may include Beechey Island, Franklin Camp, Fort Ross and Gjoa Haven
- › See the spectacular northern lights (conditions permitting)
- › Explore the West Coast of Greenland, where you may meet with local Inuit and their dogsled teams, visit a hunting village, and learn the art of leather tanning
- › Marvel at wonders from Franklin Bay’s “Smoking Hills” to the Ilulissat Icefjord, a UNESCO World Heritage Site
- › Delve into the remote Yukon Territory at Herschel Island, where the Arctic whaling industry once thrived
- › Enjoy all-inclusive cruising, with onboard gratuities, unlimited house drinks, gear, and all excursions, Zodiac rides and port charges included on your voyage
- › Take advantage of convenient A&K charter flights to Kangerlussuaq and Anchorage, beginning and ending your journey in North America



DAY 1: Arrive Montreal, Quebec

Arrive in Montreal and transfer to your hotel. Enjoy free time to relax or explore the city independently, with our staff available at the A&K hospitality desk to assist with arrangements and reservations. Tonight, gather with your A&K Expedition Team for a welcome cocktail reception and dinner to celebrate the start of your adventure. *Fairmont Queen Elizabeth* | *Meals: D*

DAY 2: Montreal | *Dynamic French-English City*

After breakfast this morning, enjoy the opportunity to explore this modern and culturally rich Canadian city with a choice of engaging tours, each arranged to fit a variety of activity levels. *Fairmont Queen Elizabeth* | *Meals: B*



DAY 3: Kangerlussuaq | *Edge of Indlandsis*

Arrive by charter flight this afternoon in Western Greenland at Kangerlussuaq (Søndre Strømfjord in Danish), located on the tip of its namesake fjord and once a strategic allied stronghold during World War II. Weather and time permitting, visit the edge of the Greenland ice sheet (*indlandsis*), a vast body of inland ice covering 80 percent of the continent. En route, be on the lookout for native wildlife, such as musk oxen, reindeer, Arctic foxes, falcons and eagles. Later, arrive at the pier to board your luxurious expedition cruiser, 'Le Boreal.' Tonight, join your award-winning Expedition Team and crew for a welcome cocktail reception. *'Le Boreal'* | *Meals: B L D*



DAYS 4-8: Western Greenland | *Where Amundsen Began*

In 1906, polar explorer Roald Amundsen became the first person to successfully cross the entire Northwest Passage. Start your voyage exactly where he did: along the stunning West Coast of Greenland and north into Baffin Bay, which you explore for six days. Your enrichment and lecture program also begins, offering the first of many opportunities to delve deeper into the story of this dramatic and remote region.

Based on ice, weather and sea conditions, your Captain and Expedition Team determine the day's best sightseeing opportunities, which may include:

Sisimiut: North of the Arctic Circle, Sisimiut is both the northernmost city in Greenland able to maintain a year-round, ice-free port, as well as the southernmost town with sufficient snow for dogsledding in winter and spring. Visit the local museum with its exhibits on Inuit culture and Greenlandic colonial history, and meet a dog musher and his dogsled team.

Disko Bay & Ilulissat: Cruise into Disko Bay, a wide inlet off of Baffin Bay first explored by Erik the Red in 985, when he established the first Norse settlements in Western Greenland. Discover the Ilulissat Icefjord, a UNESCO World Heritage Site, at the sea mouth of one of the fastest and most active glaciers in the world, Sermeq Kujalleq. The scene is spectacular with giant icebergs, floating growlers and bergy bits (large chunks of glacial ice), and the sounds of the calving ice-stream. Take a walking tour of Ilulissat, including a visit to the local history museum, and meet with villagers to learn about life in this often-harsh Arctic region. Enjoy a huskie dogsled demonstration and learn about the centuries-old methods of leather tanning, still in practice today.

Uummannaq Fjords: Located north of Ilulissat, the Uummannaq Fjord System is an awe-inspiring geological wonder teeming with marine life. Visit Karrat ø to enjoy the stunning view of the iceberg-studded bay and also discover the remains of ancient huts, made of whale bones and sod by traditional Thule hunters (ancestors of the Inuit) some 500 to 1,000 years ago.

Upernavik: Founded in 1772, this summer camp for nomadic Greenland Inuit was an ideal hunting ground for whales, seals and fish. Witness this for yourself when you spend time with



POLAR BEARS ON ICE

Venturing high into the Canadian Arctic can reveal a sight rarely seen: polar bears on ice, floating right beside your vessel.



ILULISSAT ICEFJORD

A UNESCO World Heritage Site off the coast of Greenland, this massive fjord is one of the most active glaciers in the world — and you may explore its icebergs by Zodiac.



JOURNEY HIGHLIGHTS

The Northwest Passage: From Greenland to the Bering Sea promises unparalleled adventures, including these extraordinary highlights.



ULUKHAKTOK CULTURE

At the shores of remote Ulukhaktok in Canada's Northwest Territories, guests receive an incredible welcome from this traditional Inuit community, complete with food and dancing.

NORTHERN LIGHTS

Voyagers into the High Arctic are rewarded with spectacular shows of the aurora borealis, which envelope the skies down to the horizon (conditions permitting).



EXPLORE THE NORTHWEST PASSAGE NOW



Visit our blog to dive into our most recent Northwest Passage journey, experiencing stories and videos from this pristine passage and epic A&K luxury expedition cruise.

abercrombiekent.com/blog



local villagers who still maintain a traditional way of life, living off the fish and seal populations common to the region. Visit the shops, church and local museum, the last of which offers an excellent display of Greenlandic life. *'Le Boreal'* | *Meals: B L D*



DAYS 9-18: Nunavut & the Canadian Arctic Archipelago | *Heart of the Northwest Passage*

Cruise west across Baffin Bay and into the Canadian Arctic Archipelago of Nunavut, where you begin your journey to the heart — and history — of the Northwest Passage. The A&K Expedition Team continues to share captivating lectures to enhance your own discovery.

As *'Le Boreal'* winds its way through legendary channels and inlets, your crew and Expedition Team determines the best route based on ice, weather and sea conditions. Exciting excursions await and are likely to include:

Pond Inlet: Located on the Northern end of Baffin Island, Pond Inlet, which translates to “Place of Mittima’s Grave,” is the noted gateway to the fabled Northwest Passage and a rich archaeological site. After clearing customs formalities for Nunavut, set off for a shore excursion to an area originally inhabited by the ancient Thule. Visit the Nattinnak Visitor’s Center or Toonoonik Sagoonik Co-op, where you can shop for artisan carvings made from local red and green soapstone, beautiful wall hangings, and other handcrafted goods.



Fort Ross: An abandoned trading post on the tip of Somerset Island, Fort Ross was founded in 1937 as a place for trappers to barter Arctic fox pelts in exchange for food and necessities. Explore the remaining wooden buildings of the post, which closed in 1948, and imagine life in such a barren landscape. Keep an eye out for bowhead whales or, perhaps, take a Zodiac excursion to CoBay, where polar bears have been known to feed.

Gjoa Haven: During his first attempt to transit the Northwest Passage on ‘Gjøa,’ Roald Amundsen used this natural harbor as a respite while waiting for ice conditions to improve. For two years, he lived with the Netsilik Inuits, learning their skills for survival and more efficient travel, which would later prove invaluable in his successful South Pole expedition. Today, Gjoa Haven has a population of 1,200 and still bears the historic significance of playing a key role in polar exploration.

Victoria Island: Cruise along the south coast of Victoria Island, which straddles both Nunavut and the Northwest Territories, voyaging through Queen Maud Gulf, Dease Strait and Coronation Gulf. Expedition stops may include bird sanctuary Jenny Lind Island, where you may also spy its populations of musk ox, and Johansen Bay, home to the remains of a nomadic trapper basecamp. Your Expedition Team may also lead you to Ulukhaktok (Holman village) in Queen’s Bay for an unforgettable visit with its local Inuit people. Only in contact with the rest of the world since the middle of the 19th century, the people of Holman continue to practice a traditional lifestyle and represent surprising cultural diversity; experience both with a warm welcome at the shore, drum dances, fresh char and bannock rings (fried dough) prepared over an open fire, and tours of the town art center. Ulukhaktok is famous for its printmaking and you bear witness to the beautiful tradition here; also find carvings, hats made of coveted qiviut (musk ox wool) and ulus: traditional, half-moon-shaped knives used by women to prepare food and skins. *‘Le Boreal’ | Meals: B L D*

Lancaster Sound: Situated between Devon Island and Baffin Island, this body of water forms the eastern entrance to the Parry Channel and the Northwest Passage. It’s also home to a rich abundance of Arctic cod, which in turn draws copious populations of sea birds and marine mammals. Beluga and endangered bowhead whales, the narwhal with its spiraling tusk, ringed and bearded seals, the enchanting polar bear and mustached walrus, as well as northern fulmars, black guillemots and Arctic terns — all are among the fantastic wildlife that inhabit the area. Some may even come into view on thrilling Zodiac excursions and landings.

Beechey Island: Historic moments in Arctic exploration define this island, best known for providing a safe haven to British explorer Sir John Franklin in 1845. Look east toward Resolute Bay at the huge silhouette of Cape Riley and imagine what Captain Franklin saw here in Erebus Harbour, where he took shelter for two years before his ill-fated attempt to conquer the Northwest Passage. See the wooden grave markers for three of Franklin’s men, now bleached by the sun, and visit the cenotaph memorial erected in memory of the lost explorer. It is an unforgettable experience.



DAY 19: Franklin Bay & the “Smoking Hills” | *Endless Fire*
In the Northwest Territories at Franklin Bay, see the spectacular and enormous “Smoking Hills,” cliffs of bituminous shale that endlessly combust and burn. This rare geological phenomenon has likely been occurring for millennia, with layers of the



relatively unstable mineral jarosite covering these hills. When the mineral comes into contact with cold air, it becomes red-hot and produces a thick, black smoke — a fantastic sight not unlike the smoky fumaroles produced by volcanoes, though far rarer to see. *'Le Boreal' | Meals: B L D*



DAY 20: Herschel Island & the Yukon Territory | *Safe Haven in the Farthest Reaches*

During a long mapping expedition in 1826, Captain Franklin was the first European to lay eyes on this unique island at the northernmost point of the Yukon Territory. Named by Franklin, Herschel Island is a landmark in the West Arctic and has since served alternately as a whaling station, relay station and refuge for travellers. The island's summer populations of wildlife include walrus, moose, musk ox, Arctic fox and 94 species of birds. It is also one of the only places on earth where you may see a grizzly bear, black bear and polar bear, the last of which live along the ice edge in summer. Evidence of the island's whaling culture and Thule Inuit predecessors remains near the shoreline, though it may not for much longer; the island is subject to extreme coastal erosion and scientists predict the shoreline will disappear under the waves within 50 years.

'Le Boreal' | Meals: B L D

THE NORTHWEST PASSAGE: A LEGACY OF EPIC EXPLORATION

To sail the Northwest Passage—the sea route linking the Atlantic and Pacific oceans—is a goal that has fired the imaginations of seafaring explorers and traders for centuries. Like the search for the source of the Nile or the city of Troy, the quest to conquer it is the stuff of legend.

The Lure of the Arctic Grail

Courage, skill, perseverance and no small amount of luck were once the prerequisites for anyone attempting to conquer the Northwest Passage, some 500 miles north of the Arctic Circle. It wasn't until the early 20th century that the daunting feat was finally accomplished.

Since then, no more than a few thousand hearty souls have transited the entire route. And while it remains an exclusive club, it's one Abercrombie & Kent invites you to join in 2018.

“The Northwest Passage is unique, a voyage that can be done only with a specific vessel during a very short period of the year,” notes A&K's Captain Etienne Garcia. “It's a historical voyage in the wake of great explorers like Roald Amundsen and Robert McClure. Altogether, this makes for a very special cruise.”

Over the last four centuries, countless explorers sought to traverse the passage, vying with the shifting ice for the sake of king and commerce, making varied degrees of progress, but never achieving success. Many turned back due to ferocious weather or intractable ice, while a few likely regretted not having done so, including Captain Sir John Franklin, whose lost expedition remains a mystery today.

The journey was at last successfully completed by McClure, an Irishman in command of the British ship 'Investigator,'

who crossed from west to east between 1850 to 1854. McClure, however, travelled by both boat and sledge, and it was not until Norwegian polar explorer Amundsen finished a three-year expedition in 1906, that someone finally traversed the length of the passage entirely under sail. It would take until 1969 for the first commercial vessel to successfully navigate the passage.



A Wildly Telling Landscape

A&K Expedition Team member Ralph Eshelman shares a passion for this passage and its place in the greater scheme of east-west exploration. “As a maritime historian and geologist, this part of the world fascinates me,” says Ralph. “Most folks don't realize that the Northwest Passage is actually a series of several different passages, not just one. Ice conditions often influence exactly what the passage may be.

“Some of the oldest rocks on earth are found here. Amazingly, despite the cold, there are fossils of dinosaurs and trees that tell a story of a once warmer climate. In the absence of vegetation today, these rocks are clearly visible. And when snow and ice recede, a glimpse of a geological wonderland that few travellers ever witness is revealed.”

An Unparalleled Voyage

Ready for more? Join us to explore firsthand and alongside A&K's remarkable Expedition Team on our 2018 voyage, **The Northwest Passage: From Greenland to the Bering Sea.**



An illustration of Sir John Franklin's Northern Arctic exploration



**DAYS 21-22: Beaufort & Chukchi Seas |
*Waters of the White One***

Typically dense with ice floes and fog, the Beaufort Sea opens up a 60-mile-wide coastal pass from August to September. From here, 'Le Boreal' cruises into the U.S. and clears at Point Barrow, Alaska. Sailing in the comfort of your luxury expedition cruiser, continue participating in eye-opening lectures led by the Expedition Team. Be on the lookout across the sea for bowhead

and beluga whales, the latter of which sustain one of the largest populations in the world here. Still hunted on a sustenance quota basis by local Inuit, the sociable creatures often travel in numbers and are said to be quite "chatty," with their trills, clicks and squeals audible above the surface. In the late evening, relax on your private balcony or join fellow guests out on deck to witness the northern lights, known for delivering a stunning display in autumn (conditions permitting). Your voyage continues through this narrow passage between North America and the ever-changing Arctic ice cap. *'Le Boreal'* | *Meals: B L D*

DAY 23: Little Diomedes | *Along the Alaskan Coast*

Continue cruising through the Bering Sea to Little Diomedes, an island that sits between Alaska and Russia at the edge of the International Dateline. Disembark for a Zodiac cruise of the island, where the Ingalikmiut still maintain a traditional lifestyle of hunting, fishing and egg gathering. In line with customs and necessity, the Ingalikmiut also use seal, walrus and polar bear hides to make clothing, parkas, hats and mukluks, as well as trade currency for bartering. *'Le Boreal'* | *Meals: B L D*



DAY 24: Nome, Alaska | Gold Rush Fever

Arrive and disembark in Nome, Alaska, among the wildest reaches of mainland America and the final destination for the Iditarod dogsled competition. Gold can still be mined here and you enjoy the opportunity to try gold panning; also experience a dogsled demonstration and a stop at the Bering Sea Land Bridge National Monument visitor's center. Following lunch at Old St. Joe's Church, take advantage of time to explore the downtown area of Nome. Transfer to the airport for your A&K charter flight to Anchorage. Continue on your home-bound flight or extend your stay in Anchorage. *Meals: B L*



Anchorage Post-Cruise Extension

4 days from \$2,495

- DAY 1: Discover historic Anchorage with a city tour and a docent-led visit at the Anchorage Museum, which features an expansive collection of art and culture. *Hotel Captain Cook*
- DAY 2: Ride the rails north to Talkeetna and visit with a bush pilot, who reveals the intricacies of flying in Alaska. *Hotel Captain Cook | Meals: B*
- DAY 3: Visit the Alaska Wildlife Conservation Center, pan for gold, ride a cable car to the top of Mount Alyeska and enjoy a farewell dinner. *Hotel Captain Cook | Meals: B L D*
- DAY 4: Transfer to the airport for your flight home. *Meals: B*



'LE BOREAL' STATEROOMS & SUITES

DATES & PRICING	BUTLER SERVICE INCLUDED							
	Category 1	Category 2	Category 3	Category 4	Category 5	Category 6	Category 7	Category 8
Guaranteed Departure Date	Classic Balcony Stateroom	Deluxe Balcony Stateroom	Premier Balcony Stateroom	Superior Balcony Stateroom	Prestige Balcony Suite	Premier Two-Room Balcony Suite	Prestige Two-Room Balcony Suite	Owner's Balcony Suite
Aug 18-Sep 10, 2018	\$30,995	\$33,495	\$35,995	\$36,995	\$41,995	\$43,995	\$46,995	\$55,495
Early Booking Discount Price*	\$27,995	\$30,495	\$32,995					
Single Supplement	\$15,495	\$16,745	\$21,595	\$22,195	\$39,895	\$41,795	\$44,645	\$52,725

Internal Air: Economy class from \$2,750

Montreal/Kangerlussuaq; Nome/Anchorage

*Book categories 1-3 by Oct 31, 2017, and save up to \$6,000 per stateroom.

Journey Details

This journey contains some active elements and is subject to change based on weather, wildlife, ice and other conditions beyond A&K's control. The final itinerary will be determined at the sole discretion of the Captain and Expedition Leader. Minimum age is 10 years. Butler service is included in Suite categories 5-8.

First group event: reception and dinner in Montreal, Canada at approximately 7:00 p.m. on Day 1. Last group event: lunch in Nome, Alaska at approximately 12:00 p.m. on Day 24.

“The ship was phenomenal. We absolutely wanted a balcony
and every cabin on board has one. We felt taken care of and safe.
The A&K reputation absolutely delivered.”

— David; San Diego, CA, December 2016



LUXURIOUS SISTER SHIPS TO TAKE YOU THERE

Remarkable style, strength and state-of-the-art nautical technology — expect no less on every exclusively-chartered A&K voyage aboard stunning ‘Le Lyrial’ and ‘Le Boreal.’



ELEGANT 'LE LYRIAL' AND 'LE BOREAL'

The ultimate in purpose-built luxury expedition cruise vessels, only when exclusively chartered by A&K.

Beauty and Convenience at Sea

From 'Le Boreal's' striking design to 'Le Lyrial's' stunning blue palette inspired by the Vega star, both luxury expedition cruisers boast a contemporary decor, and a smart and convenient layout, aided by three guest elevators. The spacious Panoramic Lounge and Terrace are ideal for social gatherings with ocean views, while the Main Lounge offers live music. The theater is a show lounge, perfect for enrichment lectures and nightly entertainment. In the library, find a range of book titles with cozy reading areas and guest computer stations with Internet access. Both ships feature an outdoor heated pool, salon and spa, steam room, and fitness center. Guests may also arrange a visit to the bridge on either vessel with the Captain.

Dining As You Wish

Each ship features two restaurants and al fresco dining by the pool. There are no formal evenings, so "dressing for dinner" doesn't mean a tuxedo or gown. Light fare and vegetarian dishes are always available, and most special diets can be accommodated with advance notice. Guests can also take advantage of complimentary 24-hour room service, including the option to enjoy breakfast in bed.

Exceptional Staterooms and Suites

Accommodations on 'Le Lyrial' and 'Le Boreal' are among the most comfortable you will find on any polar expedition cruise. Exclusively on A&K voyages, every cabin is either a stateroom or suite with an outside balcony. Bedding configurations range from king-size beds to two single beds. Two-room suites feature a sofa seating area and a king-size bed as well as the option to convert into a two-room cabin — perfect for families. In addition, 'Le Lyrial' offers more spacious suites, such as a three-room suite.

Your Personal Butler Awaits

For the ultimate in luxurious adventure cruising, complimentary private butler service is offered for all suite categories on 'Le Lyrial' and 'Le Boreal,' only when exclusively chartered by A&K. From ensuring your suite exceeds expectations to organizing cocktails on your private balcony, your personal butler is ready to tend to your every need.





'LE BOREAL' AND 'LE LYRIAL' DETAILS

- › Overall length: 466 feet
- › Beam: 59 feet
- › Draft: 15.3 feet
- › Average speed: 16 knots
- › Ice class: 1C
- › Passenger decks: 6
- › Passenger capacity: Limited to 199 (A&K charters only)
- › Crew and A&K staff: 155 (personnel-to-guest ratio of 1.3 to 1)
- › Gross tonnage: 10,700 GRT
- › Electric Motors: 2 x 2.3 MW
- › Standards: USPHS – U.S. Coast Guard's Rules Comfort Class 1 – "Clean" Ship Certification (meets or exceeds all IMO, EPA, IAATO and AECO operating standards)
- › Technology: Advanced dynamic positioning system
- › Flag: French

AMENITIES

- › English language on board
- › Private balcony with every guest cabin, exclusively offered on A&K charters only
- › Complimentary butler service with every suite category, exclusively offered on A&K charters only
- › Sun Deck and multiple outer deck observation areas
- › Outside heated pool
- › Library with selection of books
- › Two restaurants: Main and Grill
- › Open bar (excluding premium wines and spirits), an exclusive offering on A&K charters only
- › Two lounges with bars: Club with live music and Panoramic with Terrace
- › Complimentary 24-hour room service
- › Complimentary in-cabin breakfast (on request)
- › Three passenger elevators
- › Fitness Center with Kinesis® wall
- › Full-service salon with spa and steam room
- › Theater for more than 200 guests
- › Boutique shop
- › 24-hour medical facilities with certified doctor
- › Laundry services
- › Electricity: 110/220 volts
- › Wireless Internet (due to remote destinations, access and speed varies)

'LE LYRIAL' DECK PLAN

With a sweeping modern palette that takes inspiration from one of the brightest stars in the sky, stylish 'Le Lyrial' makes a grand statement in polar waters, complete with her multitude of suites and luxurious comforts.



Savor fine dining on board

Our welcoming staff is always on hand to help



Unwind in the Club Lounge



Enjoy expert lecturers in the theater

CATEGORIES FOR STATEROOMS & SUITES

BUTLER SERVICE INCLUDED

- **Category 9**
Owner's Balcony Suite
- **Category 8**
Grand Privilege
Three-Room Balcony Suite
- **Category 7**
Grand Deluxe Two-Room
Balcony Suite
- **Category 6**
Privilege Two-Room
Balcony Suite
- **Category 5**
Premier Two-Room
Balcony Suite
- **Category 4**
Prestige Balcony Suite
- **Category 3**
Premier Balcony Stateroom
- **Category 2**
Deluxe Balcony Stateroom
- **Category 1**
Classic Balcony Stateroom

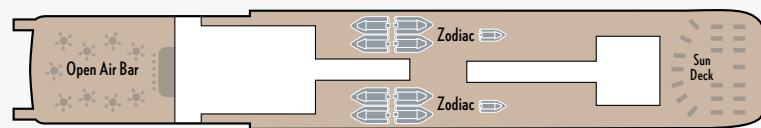

DECK 7

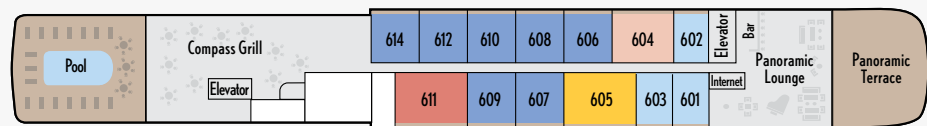

DECK 6

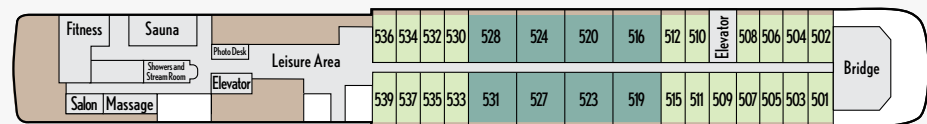

DECK 5

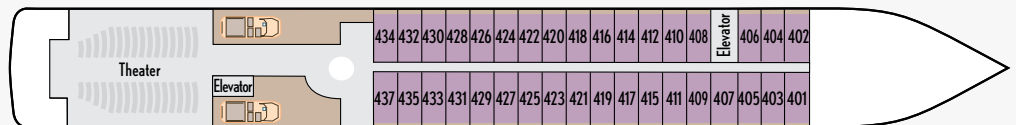

DECK 4

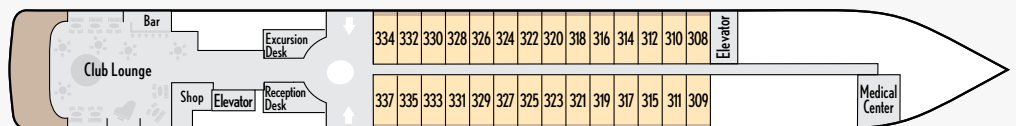

DECK 3

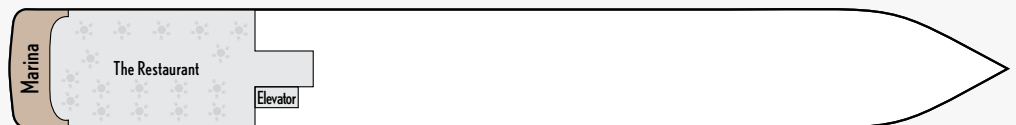

DECK 2

'LE LYRIAL' STATEROOMS AND SUITES



Upgrade to a spacious Grand Privilege Three-Room Balcony Suite

Gaze out to sea from a Balcony Stateroom

— BUTLER SERVICE INCLUDED —

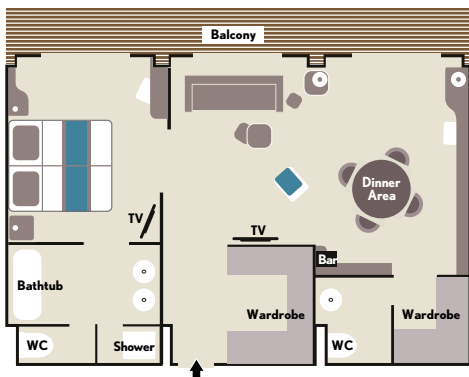

OWNER'S BALCONY SUITE (Category 9)

Cabin: 581 sq. ft. (54 sq. m.)
Balcony: 129 sq. ft. (12 sq. m.)

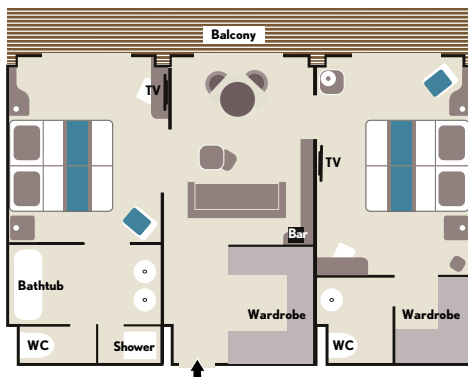

GRAND PRIVILEGE THREE-ROOM BALCONY SUITE (Category 8)

Cabin: 581 sq. ft. (54 sq. m.)
Balcony: 129 sq. ft. (12 sq. m.)

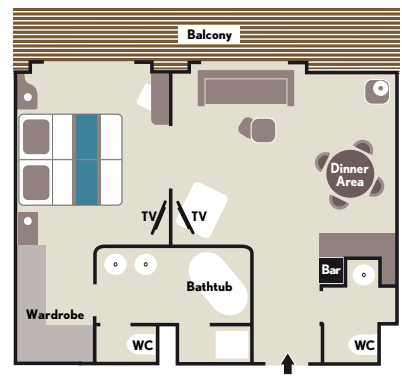

GRAND DELUXE TWO-ROOM BALCONY SUITE (Category 7)

Cabin: 484 sq. ft. (45 sq. m.)
Balcony: 108 sq. ft. (10 sq. m.)



Stretch out in a Grand Deluxe Two-Room Balcony Suite



Retreat to a comfortable Balcony Stateroom

BUTLER SERVICE INCLUDED

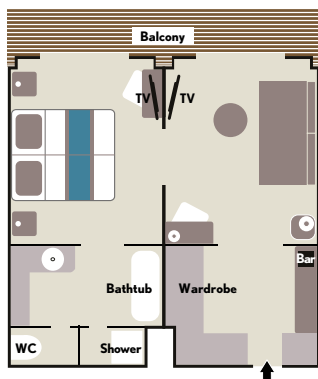

PRIVILEGE TWO-ROOM BALCONY SUITE (Category 6)

Cabin: 388 sq. ft. (36 sq. m.)
Balcony: 86 sq. ft. (8 sq. m.)

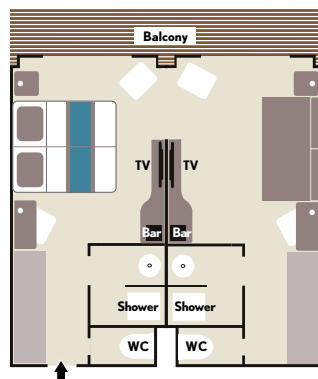

PREMIER TWO-ROOM BALCONY SUITE (Category 5)

Cabin: 388 sq. ft. (36 sq. m.)
Balcony: 86 sq. ft. (8 sq. m.)

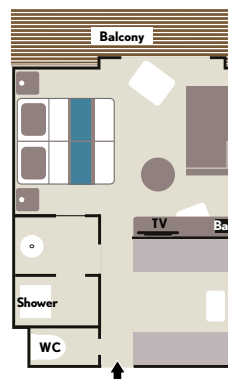

PRESTIGE BALCONY SUITE (Category 4)

Cabin: 291 sq. ft. (27 sq. m.)
Balcony: 65 sq. ft. (6 sq. m.)

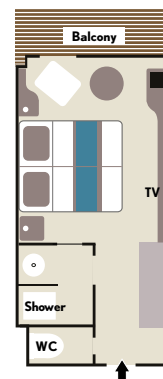

BALCONY STATEROOMS (Categories 1-3)

Cabin: 200 sq. ft. (18 sq. m.)
Balcony: 43 sq. ft. (4 sq. m.)

'LE BOREAL' DECK PLAN

Sophisticated design and all the right luxuries defines vibrant 'Le Boreal,' which features all-balcony staterooms only when chartered by A&K — just like her sister ship, 'Le Lyrial.'



Look forward to entertaining presentations in 'Le Boreal's' theater



Stop by 'Le Boreal's' Reception Desk with any request, large or small



Take in the view from the Panoramic Lounge



Experience elegance at every turn

CATEGORIES FOR STATEROOMS & SUITES

BUTLER SERVICE INCLUDED

- **Category 8**
Owner's Balcony Suite
- **Category 7**
Prestige Two-Room Balcony Suite
- **Category 6**
Premier Two-Room Balcony Suite
- **Category 5**
Prestige Balcony Suite
- **Category 4**
Superior Balcony Stateroom
- **Category 3**
Premier Balcony Stateroom
- **Category 2**
Deluxe Balcony Stateroom
- **Category 1**
Classic Balcony Stateroom

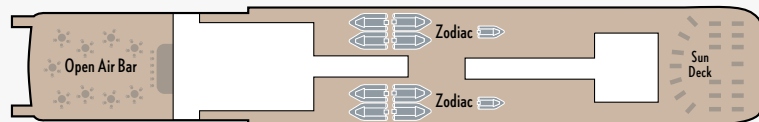

DECK 7

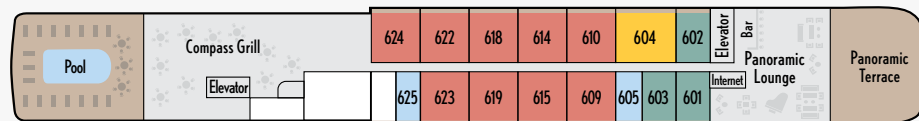

DECK 6

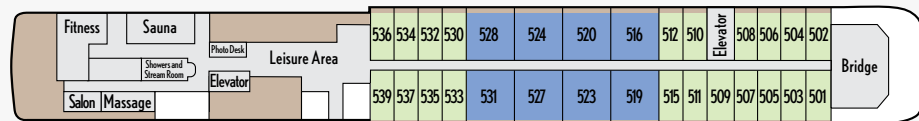

DECK 5

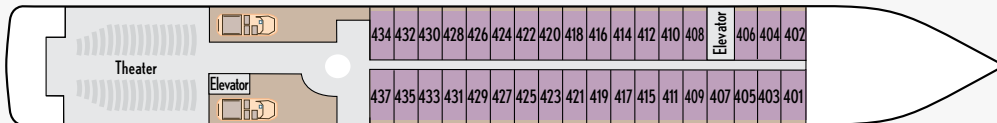

DECK 4

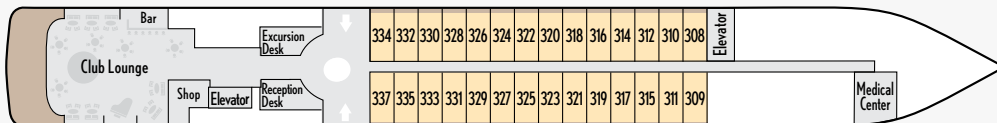

DECK 3



DECK 2

'LE BOREAL' STATEROOMS AND SUITES

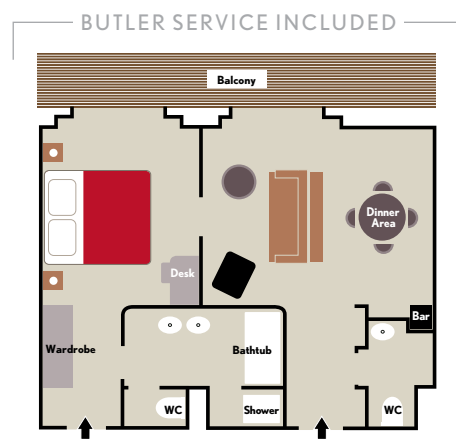

OWNER'S BALCONY SUITE (Category 8)

Cabin: 484 sq. ft. (45 sq. m.)
Balcony: 97 sq. ft. (9 sq. m.)



Indulge in the spacious Owner's Balcony Suite



Rest easy in a Prestige Balcony Suite

BUTLER SERVICE INCLUDED

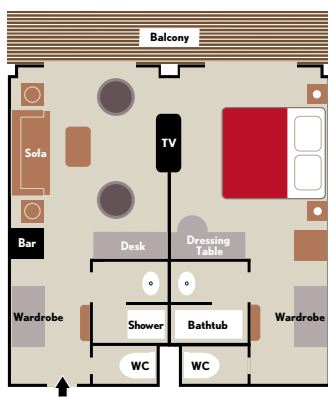

PREMIER AND PRESTIGE TWO-ROOM BALCONY SUITES (Categories 6-7)
Cabin: 400 sq. ft. (37 sq. m.)
Balcony: 86 sq. ft. (8 sq. m.)

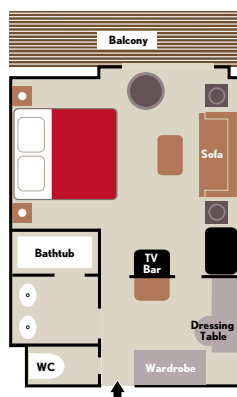

PRESTIGE BALCONY SUITE (Category 5)
Cabin: 290 sq. ft. (27 sq. m.)
Balcony: 54 sq. ft. (5 sq. m.)



BALCONY STATEROOMS (Categories 1-4)
Cabin: 200 sq. ft. (18 sq. m.)
Balcony: 43 sq. ft. (4 sq. m.)

TERMS & CONDITIONS

These Abercrombie & Kent USA, LLC ("A&K") Terms and Conditions apply to group journeys including Luxury Small Group, Marco Polo, Family, Connections, Connections European River Cruise, Celebration and Wings Over the World Journeys, as well as Group Pre- and Post-Tour Extensions, departing between January 1, 2018, and December 31, 2018; Luxury Expedition Cruises departing between March 1, 2018, and February 28, 2019; and bookings for future years until updated. For all other terms and conditions including all journeys to Cuba and Signature Series Journeys, please refer to abercrombiekent.com.

GUARANTEED DEPARTURES

All group journeys excluding Connections European River Cruise, Luxury Expedition Cruises, Private Jet, Wings Over the World, and Inspiring Expeditions by Geoffrey Kent are guaranteed to operate with a minimum of two (2) persons. Guaranteed departures will operate except only in cases of force majeure, which could include any major world event adversely affecting international travel patterns or other circumstances beyond A&K's control.

A&K PRICE ASSURANCE

The A&K Price Assurance applies to all group journeys available through A&K excluding Luxury Expedition Cruises, Private Jet, Inspiring Expeditions by Geoffrey Kent, international and internal air and extra services. The A&K Price Assurance applies only to advertised rates on abercrombiekent.com for the same program, travel date and accommodation classification. A&K reserves the right to modify or cancel the A&K Price Assurance for future bookings without prior notice.

INCLUDED IN JOURNEYS

All accommodations, meals and fully guided sightseeing (including park and entrance fees) as noted in the itinerary; airport transfers to/from hotel/ship in the first/last published city regardless of day of arrival and departure (on Expedition Cruises, transfers may be included on start and end dates only); services of A&K Resident Tour Director or appropriate Guide on Pre- and Post-Tour Extensions; coffee/tea/soft drinks/water at included meals; local wine and beer at all designated welcome and farewell dinners except for Iran journeys and with all lunches and dinners on Connections European River Cruise Journeys; local bottled water during sightseeing; portage of two (2) pieces of baggage; complimentary Internet access (where available on land and Connections European River Cruise Journeys; excluded on all other cruises and trains; service levels are not guaranteed); hotel taxes; and gratuities throughout, except to the Resident Tour Director/Extension guide/East Africa safari driver-guides.

Luxury Small Group, Marco Polo, Family and Wings Over the World Journeys Additional Inclusions:

A&K's Travelling Bell Boy Service is provided; however, because of security regulations, this service may be limited at airports, rail stations and points of embarkation for cruises. A&K's Traveller's Valet includes laundry service for eight (8) pieces (excludes Pre- and Post-Tour Extensions and Mount Kilimanjaro). Dry cleaning is not included.

Expedition Cruises (Antarctica, Arctic and Japan)

Additional Inclusions:

Complimentary standard bar drinks, beer, house wine, soft drinks, coffee drinks, juices and bottled water (excluding premium wines, spirits and Champagnes) while on board; all shore excursions and full lecture program while on board; services of an A&K Expedition Staff and local guides; gratuities for the ship's crew and A&K Expedition Staff; a post-cruise expedition logbook; and a complimentary expedition parka and backpack provided on board Antarctica/Arctic cruises.

Africa Journeys Additional Inclusions:

Medical evacuation service, when available, including air transportation to medical care facilities, is included within Kenya, Tanzania, Botswana, Zambia and Zimbabwe. For Climb Kilimanjaro program participants, medical evacuation is included from the foot of Mount Kilimanjaro to Nairobi. Hospitalization and medical expenses are at an additional cost.

NOT INCLUDED IN JOURNEYS

A&K's Guest Protection Program; international and internal airfares, unless otherwise noted; costs associated with obtaining passports or entry visas; reciprocity and other border fees; airport departure taxes, unless otherwise noted;

excess baggage charges; gratuities to the Resident Tour Director/Extension guide/East Africa safari driver-guides; meals other than those specified in the itinerary; beverages other than those noted in inclusions above; sightseeing not included in the published itinerary; and personal expenses such as laundry (except for A&K's Traveller's Valet as noted), communication charges, Internet access for all trains and cruises except Connections European River Cruise Journeys; and optional activities (which are subject to availability).

HOTEL CHECK-IN

Most hotels allow check-in to take place during the midafternoon. Should you wish to have a guaranteed room ready for your immediate check-in upon arrival, it can be arranged for an additional charge. Please ask A&K for details and prices.

ROOM UPGRADES/SPECIAL REQUESTS

Upgrades are available on request at individual hotels. Specific requests such as adjacent or connecting rooms, bedding requests, smoking rooms and special dietary needs should be advised at time of booking. Please note that while every effort will be made to secure a special request, it cannot be guaranteed.

ITINERARIES

A&K reserves the right to modify program itineraries, including arranged sightseeing, and substitute accommodations, including vessels, aircraft and trains, at any time due to unforeseen circumstances or circumstances beyond A&K's control. Every effort will be made to operate itineraries as planned, but alterations may occur after the final itinerary has been issued.

AIR TRANSPORTATION

International airfare (to the journey starting point and from the ending point) is not included in program pricing. A&K has special agreements with many air carriers and can offer quotations from any gateway. Some journeys require internal flights as specified in the itinerary. This airfare is typically not included and must be purchased from A&K in addition to the journey. In the instance where charter flights are used and seating is limited, A&K reserves the right to substitute and confirm air reservations on a suitable alternative scheduled air flight. All internal air is based on economy class seating and is 100% non-refundable at time of final payment (some exceptions may apply). All international and internal air quotes are subject to change until final payment has been received by A&K. Flight confirmation is based on availability. Air reservations cannot be confirmed until a passport copy is received by A&K.

All air carriers are independent contractors and are not owned, managed, controlled or operated by A&K. Your airline ticket constitutes a contract between yourself and the airlines (and not A&K), even if purchased through A&K. A&K is not liable for, and does not assume responsibility or accept claims with regard to, seat assignments, name changes, schedule changes, flight changes and/or cancellations. Should you change or cancel your air transportation arrangements before or after your travel begins, all airline change and cancellation fees will apply.

BAGGAGE

A&K provides portage of two (2) pieces of baggage per person. Please note should your journey include internal/domestic or charter flights, your luggage allowance may be less than two (2) pieces of baggage and weight/size restrictions and additional costs may apply.

Details will be provided in your Pre-Travel Documentation. Baggage and personal effects are at the owner's risk throughout the travel program, and A&K assumes no liability for lost or damaged baggage. Please check with your international carrier for other baggage restrictions and fees applicable to your international flights.

PRICES AND ARRANGEMENTS

Quoted program prices are per person, double occupancy except where indicated. Marco Polo Club discount is not eligible on Connections and Connections European River Cruise Journeys for memberships established prior to November 1, 2015. For full program terms and conditions visit akmarcopolo.com. Marco Polo Journeys have two prices; a higher price that allows us to guarantee departures for small groups of two to six guests and a lower price for groups of seven or more guests. The higher price will be noted on your initial invoice and reduced before you depart if your group has seven or more guests. Although not expected, published prices may be modified due to unexpected significant external factors not forecasted at the time of printing. A&K

is under no obligation to give a breakdown in costs of any journey. Pre- and Post-Tour Extensions are only available to guests booked on related group journeys. Modification of program content to accommodate a smaller group size will not affect the published program price.

CHILD POLICY

The minimum age is 10 years old unless noted on the itinerary and all children under age 18 must be accompanied by an adult. Minimum age is 18 years for Iran journeys, 12 years old for Connections European River Cruise Journeys and varies for Family Journeys. Some activities contained within an itinerary may have a different age restriction than the overall minimum age requirement. Details will be provided at the time of booking. A&K reserves the right to marginally exceed the published maximum group size on Family Journeys to accommodate a family.

ACTIVE ELEMENTS & CONDUCT

Some active elements have been incorporated into select itineraries. To enjoy the trips as intended, a minimum level of fitness is required. A&K will require prior notice if any participant has any physical or other condition or disability that would prevent them from participating in active elements of any trip and/or could create a hazard to him or herself or to other members of the group. Due to ship restrictions, women over six (6) months pregnant are not permitted to travel on Expedition Cruises. The guest represents that neither he nor she nor anyone travelling with him or her has any physical or other condition or disability that could create a hazard to himself or herself or other members of the tour. A&K reserves the right to decline acceptance of anyone whom it considers unsuitable due to fitness level. A&K also reserves the right to remove from the trip, at the participant's own expense, anyone whose physical condition or conduct negatively impacts the enjoyment of the other guests or disrupts the tour.

A&K'S GUEST PROTECTION PROGRAM

Our Guest Protection Program, which provides cancellation coverage, medical coverage and protection against lost or damaged luggage, is not included in the program price and is recommended. The plan must be purchased within 14 days of deposit in order to waive the pre-existing medical condition exclusion. Call A&K for details.

Special Requirement for Antarctica and Arctic Cruises:

Due to the remote locations, A&K requires proof of a minimum of \$50,000 per person in emergency evacuation/repatriation insurance for all Antarctica and Arctic cruises. This minimum amount is included in the A&K Guest Protection Program; upgrades can be purchased for higher coverage on request. If you do not purchase the A&K Guest Protection Program, we require proof of alternative coverage. Please note emergency evacuation insurance provides for covering the cost associated with emergency evacuation and repatriation up to the limits of the respective policy; however, it does not guarantee the timing, method or mode of such evacuation and repatriation, which is subject to weather, location and other conditions or variables outside of A&K's control.

PASSPORTS AND VISAS

It is the guest's sole responsibility to obtain and have available when necessary the appropriate valid travel documents. All guests are advised to check with the appropriate government authority to determine the necessary documents. A valid passport is required for U.S. citizens travelling to all international destinations. Passports must be valid for six (6) months after the return of your journey and should also have sufficient blank visa pages for entry and exit stamps. Many destinations also require a visa for U.S. citizens; this will be indicated in your Pre-Travel Documentation. Non-U.S. citizens should contact the appropriate consular office for entry requirements pertaining to their journey. You may be refused boarding or disembarked from a vessel without liability for refund, payment, compensation, or credit of any kind if you do not have proper documentation, and you will be subject to any fine or other costs incurred by A&K which result from improper documentation or noncompliance with applicable regulations.

Special Requirement for Iran: Visas for U.S. citizens to travel to Iran must be obtained prior to arrival in Iran. Authorization is required to apply for a visa which A&K will assist you in obtaining. Instructions will be provided upon deposit. You must complete the Visa Information Form and return to A&K no later than 120 days prior to departure. Failure to provide A&K with this information will result in the cancellation of your booking and forfeiture of any monies paid.

RESERVATION AND PAYMENT SCHEDULE

Deposit per Person Required at Time of Booking	
Luxury Small Group, Marco Polo and Family Journeys	\$1,000
Connections and Connections European River Cruise Journeys	\$500
Expedition Cruises	\$2,500
Wings Over the World Journeys	\$5,000

Final payment is due 90 days prior to departure. If your reservation is made within 90 days of departure, the entire cost of the trip must be paid at the time of the request in order to secure confirmation. For all Expedition Cruise, Connections European River Cruise, Wings Over the World and Select Journeys indicated below, final payment is due 120 days prior to departure. An additional nonrefundable permit fee is required at time of booking for Uganda: Gorillas & Beyond (\$1,350 per person) and the Uganda Extension (\$600 per person).

Select Journeys: Celebration Journeys; Cruising the Mekong: Siam, Saigon & Angkor Wat; Myanmar & the Irrawaddy; Southern Africa Safari by River & Rail; Taj Mahal & the Treasures of India (Holiday and Pushkar Fair departures); India Wildlife Safari: Lions, Tigers & Leopards; Legends of the East by Luxury Train: Bangkok to Singapore & Bali; Mongolia: Naadam Festival & the Gobi Desert; Namibia & Botswana: Dunes, Delta & the Kalahari; Paris, Champagne & Alsace: Villages & Vineyards by Barge; and Persia: A Tapestry of Ancient and Modern Iran.

CANCELLATION CHARGES

Cancellations must be received in writing and will become effective on the date of receipt, fax or email. Cancellations received by A&K are subject to the following:

CANCELLATION FEES PER PERSON

Luxury Small Group Journeys, Marco Polo Journeys, Family Journeys, Connections Land Journeys, and related Group Pre/Post Tour Extensions (except Select Journeys as listed above)	
91 days prior to departure or more	\$500
90-61 days prior to departure	20% of program price
60-31 days prior to departure	50% of program price
30 days prior to departure or less	100% of program price
Connections European River Cruise Journeys, Select Journeys listed above and related Group Pre- and Post-Tour Extensions	
121 days prior to departure or more	\$500
120-91 days prior to departure	20% of program price
90-61 days prior to departure	50% of program price
60 days prior to departure or less	100% of program price
Expedition Cruises and related Group Pre- and Post-Tour Extensions	
181 days prior to departure or more	\$500
180-121 days prior to departure	\$1,500
120-91 days prior to departure	20% of program price
90-61 days prior to departure	50% of program price
60 days prior to departure or less	100% of program price

Wings Over the World Journeys	
181 days prior to departure or more	\$2,500
180-121 days prior to departure	\$5,000
120-91 days prior to departure	50% of program price
90 days prior to departure or less	100% of program price

Partial Room Cancellation: If a guest cancels or leaves a journey and a roommate remains, an additional supplement may apply to the price for the remaining guest.

CANCELLATION CHARGES FOR INTERNAL AIR
All internal air is 100% non-refundable at time of final payment (some exceptions may apply).

CANCELLATION CHARGES FOR EXTRA SERVICES
Additional hotel nights and other extra services booked in connection with A&K journeys are subject to specific cancellation penalties. These will be provided at the time of booking and noted on the invoice.

CLAIMS AND REFUNDS

Refunds are not made for any missed services, except for verifiable extenuating circumstances. Please see our **Limits on A&K's Responsibility** clause below. For verifiable claims to be considered, they must be received in writing within 30 days of the termination of the program and be accompanied by supporting documentation and/or a statement from the local destination company verifying the claim. Any adjustment considered will be based on the actual price of the services involved and not on a per diem basis. Adjustments will not be made for unused sightseeing trips or meals. A&K will not accept any liability for any claims that are not received within 30 days of the termination of your travel program.

PHOTOGRAPHY DURING TRAVEL

A&K reserves the right to take photographs and video during the operation of any program or part thereof and to use them for promotional purposes during the program and thereafter. By booking a program with A&K, guests agree to allow their images to be used in such photographs and video. Guests who prefer that their images not be used are asked to identify themselves to their Resident Tour Director at the beginning of their program.

LIMITS ON A&K'S RESPONSIBILITY

A&K, its employees, shareholders, officers, directors, successors, agents and assigns, does not own or operate any property or entity which is to or does provide goods or services for your trip. It purchases transportation (by aircraft, coach, train, vessel or otherwise), hotel and other lodging accommodations, restaurant, ground handling and other services from various independent suppliers (including from time to time other affiliated A&K companies). All such persons and entities are independent contractors. As a result, A&K is not liable for any negligent or willful act of any such person or entity or of any third person. In addition and without limitation, A&K is not responsible for any injury, financial or physical loss, death, inconvenience, delay or damage to personal property in connection with the provision of any goods or services whether resulting from but not limited to acts of God or force majeure, illness, disease, acts of war, civil unrest, insurrection or revolt, animals, strikes or other labor activities, criminal or terrorist activities of any kind, overbooking or downgrading of services, food poisoning, mechanical or other failure of aircraft or other means of transportation or for failure of any transportation mechanism to arrive or depart on time.

There are many inherent risks in adventure travel of the type involved here, which can lead to illness, injury, or even death. These risks are increased by the fact that these trips take place in remote locations, far from medical facilities. Guest assumes all such risks associated with participating in these trips.

If you decide to participate in any activities including, but not limited to, any excursions involving animals, riding on animals, SCUBA diving, snorkeling, hot air ballooning, ziplining, high altitude treks, climbing, whitewater rafting, primate tracking and any activity which A&K considers to carry inherent risk of serious illness, injury or death ("Activities") then you fully understand and acknowledge that Activities carry with them various inherent risks, including serious illness, injury or death and you take complete responsibility for your own health and safety and

agree to assume all risks of injury, illness or death, whether foreseen or unforeseen, that may befall you as a result of participating in any Activities and agree to release A&K and its affiliates, their agents, employees and representatives from any liability whatsoever related thereto.

Further, as consideration for being permitted to participate in the Activities; you release A&K, whether known or unknown, from, and agree not to sue or make claim against A&K for, property damage, cancellation of any Activities for any reason, illness, negligent rescue operations or procedures, personal injury, or death arising out of your participation in the Activities, and any activity related thereto, including transportation to and from the site of the Activities, regardless of whether such property damage, illness, personal injury, or death results from the negligence of A&K (but not its reckless, willful, or fraudulent conduct), and/or from any defect in equipment. You further agree to indemnify and hold A&K harmless with respect to any claim made against A&K by anyone else which (a) related to your participation, or (b) which would be subject to the above release and covenant not to sue if you had made the claim directly yourself.

TRAVEL ADVISORIES AND WARNINGS

It is the responsibility of the guest to become informed about the most current travel advisories and warnings by referring to the US State Department's travel website at travel.state.gov or by phone at 888 407 4747. In the event of an active State Department Travel Warning against travel to the specific destination location(s) of the trip, should the guest still choose to travel, notwithstanding any travel advisory or warning, the guest assumes all risk of personal injury, death or property damage that may arise out of the events like those advised or warned against.

ARBITRATION AGREEMENT

Any controversy or claim arising out of or relating to these **Terms and Conditions**, to the **Limits on A&K's Responsibility** clause, to any A&K brochure, to any information regarding any A&K trip, service or package, or to any A&K-related trip, activity, service or package, shall be submitted exclusively to and resolved in binding arbitration in Chicago, Illinois under the CPR International Non-administered Arbitration Rules (which can be found at cpradr.org), before a single arbitrator appointed by CPR. Any party or their representative may appear for the arbitration by telephone or video conference. Each party shall bear its own fees, costs and expenses and an equal share of any arbitrator and administrative fees.

ANY PAYMENT TO A&K CONSTITUTES YOUR ACCEPTANCE OF THE TERMS AND CONDITIONS SET OUT HEREIN AND IN MORE SPECIFIC PRETRAVEL DOCUMENTATION, INCLUDING THE GUEST INFORMATION FORM.

A&K accepts all major credit cards.

ONE NAME: ONE UNPARALLELED STANDARD WORLDWIDE

Throughout this brochure, you'll see references to "Abercrombie & Kent" (or simply "A&K"). This is our shorthand for the many independent Abercrombie & Kent companies that work with A&K, to provide its travellers with a consistent worldwide standard of expertise and excellence in travel. Their independence allows our guests to benefit from unique local knowledge and specialized services available only from destination-based operating companies around the globe.

AMENDMENTS

A&K reserves the right to correct any errors or omissions in its published materials and to amend these Terms and Conditions at any time as the result of any material changes to legislation or regulation. All amended Terms and Conditions shall automatically be effective upon being posted by A&K to the website abercrombiekent.com. Accordingly, guests should check the website abercrombiekent.com prior to travel in order to ensure they are aware of any changes.

©2017 Abercrombie & Kent USA, LLC, ABERCROMBIE & KENT, A&K, CONNECTIONS, CONNECTIONS BY ABERCROMBIE & KENT, DESIGN YOUR DAY, INSPIRING EXPERIENCES, GUARDIAN ANGEL, MARCO POLO CLUB, MARCO POLO JOURNEYS, RESIDENT TOUR DIRECTOR, SIGNATURE SERIES, SIMPLY THE BEST WAY TO TRAVEL, TRAVELLER'S VALET, TRAVELLING BELL BOY and the ampersand design are service marks owned by A&K Sarl.

CST #2007274-20



THE JOURNEY CONTINUES ONLINE

Expedition cruising to Antarctica and the Arctic is a life-changing experience, and we want to share every bit of it with you. Our website and blog are loaded with exclusive video, photos, info and stories from A&K experts and guests alike. Visit us online today, and prepare to be inspired by the boundless wonders of Antarctica and the Arctic.



VIDEOS

Step aboard our exclusive charters to see our expeditions in action, taking in the extraordinary excursions, dining and service that set A&K voyages apart.

abercrombiekent.com/videos

BLOG

Delve into first-person stories and insider-only takes, discovering the many facets of dazzling wilderness and culture that define epic Antarctica and the Arctic.

abercrombiekent.com/blog

TRIP LOGS

Relive the magic day by day with our Trip Logs, penned by onboard A&K staff and capturing every highlight of every unforgettable day.

abercrombiekent.com/blog

GUIDE BIOS

Get to know our passionate Expedition Team, each member a seasoned polar veteran representing the best of the best in their disciplines.

abercrombiekent.com/bios

Join the conversation both on the road and at home by following **Abercrombie & Kent online** and sharing your favorite photos and stories.



MORE A&K LUXURY EXPEDITION CRUISES

CRUISE IN STYLE TO JAPAN AND GREECE

Explore more of the world's most intriguing destinations with A&K on two exciting voyages in 2018.

Wonders of Japan Cruise

May 16-29, 2018

14 days | **From \$15,495** (was \$18,495)

Limited to 199 guests

Visiting Kyoto, Osaka, Takamatsu, Hiroshima, Karatsu, Ulsen, Gyeongju, Matsue, Kanazawa, Sado/Noshiro, Aomori, Otaru and Sapporo

This extraordinary luxury expedition reveals Japan as few are lucky to experience it. On board exclusively chartered luxury vessel 'L'Austral,' visit unique ports and rarely seen wilderness areas reachable only by small ship. En route, choose from a variety of enriching shore experiences led by a team of experts on Japanese culture, history and wildlife.

- › Visit unique ports and off-the-beaten-path locales, including the port village of Karatsu
- › Enjoy fascinating onboard discussions and experiences on Japanese art and culture, history, geology, economy and horticulture
- › Choose from a wide array of shore excursions to delve deeper into Japan's culture, architecture, arts and natural history

NEW! Cruising the Greek Isles

October 10-19, 2018

10 Days | Limited to 150 guests | Call for pricing

Visiting Athens, Crete, Santorini, Rhodes, Symi, Bodrum, Delos, Mykonos and Syros

Join a singular, intimate cruise of the Greek isles on board exclusively chartered, all-new luxury vessel 'Le Laperouse.' Embark on a new itinerary, enjoying exciting excursions and sailings to breathtaking, less-frequented islands such as Symi, Delos and Syros.



To book your journey, call A&K at 800 323 7308, visit abercrombiekent.com or contact your travel professional.

ANTARCTICA CRUISE DATES & PRICING

'Le Lyrial'

CATEGORY	BUTLER SERVICE INCLUDED								
	1	2	3	4	5	6	7	8	9
	CLASSIC BALCONY STATEROOM	DELUXE BALCONY STATEROOM	PREMIER BALCONY STATEROOM	PRESTIGE BALCONY SUITE	PREMIER 2-ROOM BALCONY SUITE	PRIVILEGE 2-ROOM BALCONY SUITE	GRAND DELUXE 2-ROOM BALCONY SUITE	GRAND PRIVILEGE 3-ROOM BALCONY SUITE	OWNER'S BALCONY SUITE

CLASSIC ANTARCTICA

December 12-23, 2018

Early Booking Discount of \$3,000 if reserved by March 31, 2018, Per Person, Double Occupancy	\$11,995	\$13,495	\$14,495	BUTLER SERVICE INCLUDED					
Per Person, Double Occupancy	\$14,995	\$16,495	\$17,495	\$23,495	\$24,495	\$26,995	\$30,995	\$35,495	\$38,995
Single Supplement	\$7,495	\$8,295	\$8,795	\$21,145	\$21,995	\$24,295	\$27,895	\$33,695	\$36,045

January 6-17, 2019

Early Booking Discount of \$3,000 if reserved by March 31, 2018, Per Person, Double Occupancy	\$13,495	\$14,995	\$15,995	BUTLER SERVICE INCLUDED					
Per Person, Double Occupancy	\$16,495	\$17,995	\$18,995	\$24,995	\$25,995	\$27,995	\$32,995	\$36,495	\$39,995
Single Supplement	\$8,245	\$8,995	\$9,495	\$22,495	\$23,345	\$25,195	\$29,695	\$34,645	\$37,945

ANTARCTICA, SOUTH GEORGIA & THE FALKLAND ISLANDS

December 22, 2018-January 7, 2019

Early Booking Discount of \$4,000 if reserved by March 31, 2018, Per Person, Double Occupancy	\$17,995	\$19,995	\$20,995	BUTLER SERVICE INCLUDED					
Per Person, Double Occupancy	\$21,995	\$23,995	\$24,995	\$31,995	\$33,495	\$36,995	\$41,995	\$45,495	\$49,995
Single Supplement	\$10,995	\$11,995	\$12,495	\$28,795	\$30,145	\$33,295	\$37,795	\$43,195	\$47,495
Child (7-18 years old) sharing with adult(s) (includes additional family programming)	\$10,995	\$11,995	\$12,495	For more details, please contact A&K.					

January 16-February 1, 2019

Early Booking Discount of \$4,000 if reserved by March 31, 2018, Per Person, Double Occupancy	\$19,995	\$21,995	\$22,995	BUTLER SERVICE INCLUDED					
Per Person, Double Occupancy	\$23,995	\$25,995	\$26,995	\$34,495	\$34,995	\$38,995	\$43,995	\$48,495	\$52,995
Single Supplement	\$11,995	\$12,995	\$13,495	\$31,045	\$31,495	\$34,995	\$39,595	\$45,995	\$50,345

Note: Upgrade to suite accommodations at Palacio Duhau – Park Hyatt Buenos Aires included for ship suite categories 4 through 9.

Early booking discount is valid for categories 1-3. Offer is subject to availability and may be withdrawn at any time.

Note: Triple and quad pricing is available for categories 5, 6 and 8, two- and three-room balcony suites (upon request).

A&K CHARTER AIR

For your convenience, A&K charts your round-trip flight between Buenos Aires and Ushuaia to ensure uninterrupted, on-time boarding of your expedition cruiser.

Buenos Aires/Ushuaia/Buenos Aires From \$850

Per person, round trip. Taxes are included. All air quotes are subject to change and carry penalties and surcharges. A&K reserves the right to substitute scheduled air as needed based on charter capacity. Flight confirmations are based on availability. Please check with A&K for our special international airfares.

ARCTIC CRUISE DATES & PRICING

'Le Boreal'					BUTLER SERVICE INCLUDED			
CATEGORY	1	2	3	4	5	6	7	8
	CLASSIC BALCONY STATEROOM	DELUXE BALCONY STATEROOM	PREMIER BALCONY STATEROOM	SUPERIOR BALCONY STATEROOM	PRESTIGE BALCONY SUITE	PREMIER 2-ROOM BALCONY SUITE	PRESTIGE 2-ROOM BALCONY SUITE	OWNER'S BALCONY SUITE

ARCTIC CRUISE ADVENTURE: NORWAY, GREENLAND & ICELAND

July 27–August 10, 2018

Early Booking Discount of \$1,500 if reserved by October 31, 2017, Per Person, Double Occupancy	\$13,995	\$15,495	\$16,495		BUTLER SERVICE INCLUDED			
Per Person, Double Occupancy	\$15,495	\$16,995	\$17,995	\$19,995	\$24,495	\$25,995	\$28,995	\$32,495
Single Supplement	\$7,745	\$8,495	\$13,495	\$14,995	\$23,275	\$24,695	\$27,545	\$30,875

THE NORTHWEST PASSAGE: FROM GREENLAND TO THE BERING SEA

August 18–September 10, 2018

Early Booking Discount of \$3,000 if reserved by October 31, 2017, Per Person, Double Occupancy	\$27,995	\$30,495	\$32,995		BUTLER SERVICE INCLUDED			
Per Person, Double Occupancy	\$30,995	\$33,495	\$35,995	\$36,995	\$41,995	\$43,995	\$46,995	\$55,495
Single Supplement	\$15,495	\$16,745	\$21,595	\$22,195	\$39,895	\$41,795	\$44,645	\$52,725

Early booking discount is valid for categories 1-3. Offer is subject to availability and may be withdrawn at any time.
Note: Triple and quad pricing is available for categories 6 and 7, two-room balcony suites (upon request).

A&K CHARTER AIR

For your convenience, A&K charts your internal flights from Oslo to Longyearbyen on July 28 (Arctic Cruise Adventure: Norway, Greenland & Iceland), and from Montreal to Kangerlussuaq on August 20 and Nome to Anchorage on September 10 (The Northwest Passage: From Greenland to the Bering Sea), to ensure uninterrupted arrival to and departure from your expedition cruiser.

Arctic Cruise Adventure: Norway, Greenland & Iceland | July 27–August 10, 2018
Oslo/Longyearbyen From \$395

Per person, one way. Taxes are included. All air quotes are subject to change and carry penalties and surcharges. A&K reserves the right to substitute scheduled air as needed based on charter capacity. Flight confirmations are based on availability. Please check with A&K for our special international airfares.

The Northwest Passage: From Greenland to the Bering Sea | August 18–September 10, 2018
Montreal/Kangerlussuaq; Nome/Anchorage From \$2,750

Per person, round-trip. Taxes are included. All air quotes are subject to change and carry penalties and surcharges. Flight confirmations are based on availability. Please check with A&K for our special international airfares.

BOOK YOUR AIR WITH A&K

For the ultimate seamless travel experience, Abercrombie & Kent can arrange your international flights, guarantee rates and refund your tickets up to the day before departure. Choose from a variety of global carriers who have partnered with A&K to extend special fares and earn mileage credits from your preferred airlines. Contact A&K for details.



PROTECT YOUR JOURNEY

Travel worry-free with A&K's Guest Protection Program, which offers insurance protection in the event you are forced to cancel your trip at short notice or if a medical emergency arises while travelling. The plan also assists with replacing lost travel documents and covers you in case of baggage loss. For more information, contact A&K.

Choose from a World of Inspiring Travel



Luxury Small Group Journeys



Marco Polo Journeys

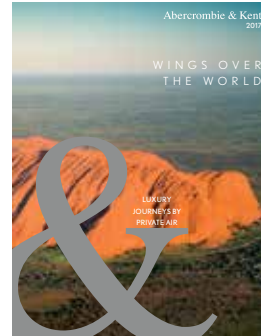

Wings Over the World Journeys

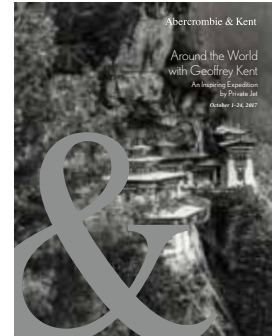

Private Jet Journeys



Connections Boutique Group Journeys

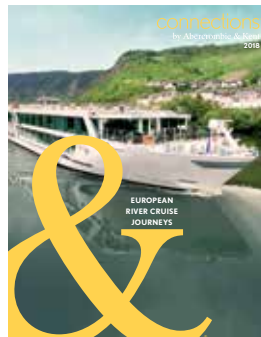

Connections European River Cruise Journeys



Family Journeys

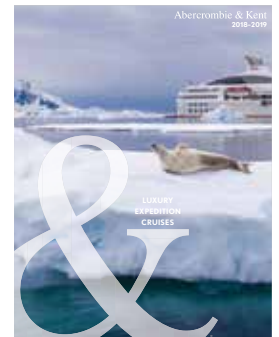

Luxury Expedition Cruises



European Canal Barge Cruises



Luxury Tailor Made Travel



Worldwide Hotel Portfolio

Contact your travel professional or Abercrombie & Kent at:

1411 Opus Place
Executive Towers West II, Suite 300
Downers Grove, IL 60515

800 323 7308 Monday-Friday (8-7 CT); Saturday (9-1 CT)

reservations@abercrombiekent.com

abercrombiekent.com



Abercrombie & Kent